

LEGEND:

FLOOR FINISH LEGEND :

F-1	POLYURETHANE-BASED EPOXY FLOOR COATING
F-2	BARE STRUCTURAL CONCRETE SLAB DEPRESSED 50MM TO RECEIVE TOPPING AND FINISH
F-3	600mm x 600mm x 8mm THK NON-SKID FLOOR TILE
F-4	600mm x 600mm x 8mm THK POLISHED FLOOR TILE
F-5	EPOXY TANK LINING
F-6	CEMENT-BASED NON-SKID WAFFLE TILE
F-7	WET-INSTALLED 20mm THK FLAMED GRANITE SLAB (PROVIDE SEALER)
F-8	TROWEL FINISH WITH PENETRATING SEALER AND HARDENER
F-9	600mm x 600mm CARPET TILES
F-10	RUBBERIZED MAT FLOORING
F-11	SIMULATED WOOD TILES
F-12	600mm x 600mm x 10mm THK POLISHED GRANITE FLOOR TILE

PARTITION TYPE LEGEND :

P-1	125mm THK. CAST-IN-PLACE CONCRETE EXTERIOR WALL
P-2	REINFORCED STRUCTURAL CONCRETE WALL
P-3	150mm THK. CHB 2HR FIRE RATED (FLOOR TO BOTTOM SLAB/BEAM) PLASTERED AND FINISH AS PER WALL FINISHED SCHEDULE
P-4	150mm THK. CHB (FLOOR TO BOTTOM SLAB/BEAM) PLASTERED AND FINISH AS PER WALL FINISHED SCHEDULE
P-5a	100mm THK. FULL HT DRY WALL PARTITION w/ 2HR FIRE RATING. GYPSUM BOARD ON METAL FURRING PLASTERED AND FINISHED AS PER WALL FINISH SCHED.
P-5b	100mm THK. 1.80M HT DRY WALL PARTITION w/ 2HR FIRE RATING. GYPSUM BOARD ON METAL FURRING PLASTERED AND FINISHED AS PER WALL FINISH SCHED.
P-6	12mm THK CLEAR SEMI-FRAMELESS FULL HT TEMPERED GLASS WALL PARTITION w/ MID-HT FROSTED STICKER BAND

WALL FINISH LEGEND :

W-1	SEMI-GLOSS LATEX PAINT FINISH
W-2	300X600X25mm THK. POLISHED HOMOGENOUS WALL TILE
W-3	600X600X25mm THK. POLISHED HOMOGENOUS GRANITE WALL TILE
W-4	EPOXY LINING
W-5	LIQUID-APPLIED ELASTOMERIC WALL COATING
W-6	LIQUID-APPLIED ELASTOMERIC WALL COATING + DRY-INSTALLED GRANITE SLAB ON STAINLESS STEEL ANCHORS
W-7	PAINTED FINISH WITH TRAFFIC STRIPE PATTERN
W-8	DECORATIVE WALL STICKER ON SKIM COAT WALL COATING
W-9	ACOUSTIC PADDING

CEILING FINISHES LEGEND :

C-1	LOW SHEEN ACRYLIC LATEX PAINT ON SMOOTH RUBBED FINISHED EXPOSED UNDERSIDE OF SLAB/ BEAM
C-2	LOW SHEEN ACRYLIC LATEX PAINT ON 12mm THK MOISTURE RESISTANT GYPSUM BOARD ON METAL CEILING JOIST
C-3	600X600 REGULAR ACOUSTIC TILES ON POWDER COATED ALUMINUM T RUNNERS
C-4	POWDER COATED ALUMINUM PANELS ON CONCEALED ALUMINUM RUNNERS
C-5	12mm THK. GYPSUM BOARD IN HPL METAL FIN. AND 6mm THK. GRAPHICOTE GLASS PANELS ON POWDER COATED ALUMINUM FRAMING WITH 6mm THK. ACRYLIC DIFFUSERS
C-6	LOW SHEEN ACRYLIC LATEX PAINT ON 12mm THK GYPSUM BOARD ON METAL CEILING JOIST
C-7	ALUMINUM COMPOSITE CEILING PANEL
C-8	LOW SHEEN ACRYLIC LATEX PAINT ON 12mm THK GYPSUM BOARD HEXAGONAL ACCENT DROP CEILING + 20mm DIA x 150mm THK ON METAL HANGERS

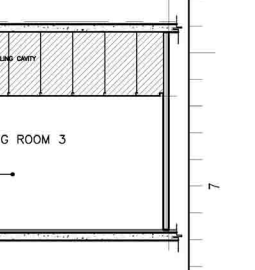
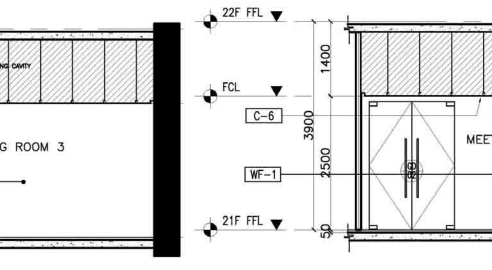
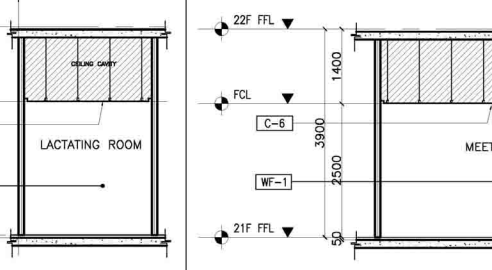
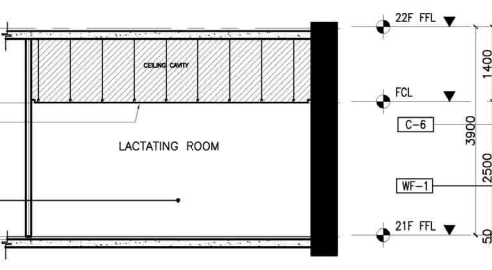
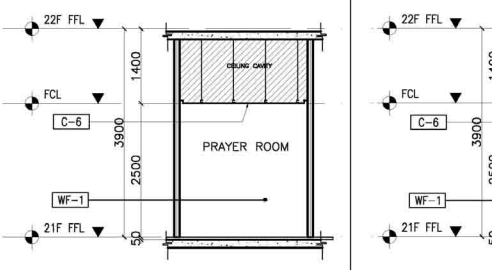
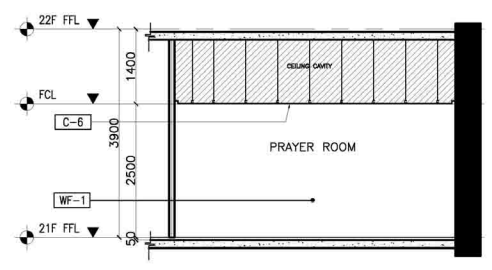
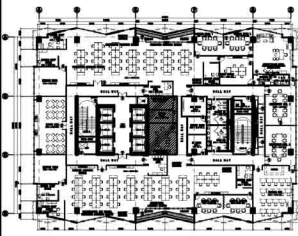
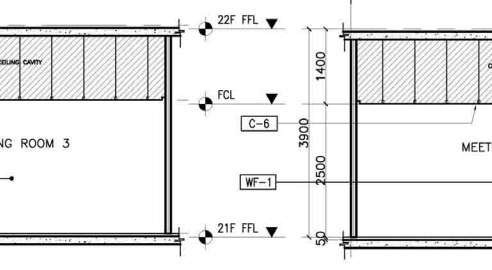
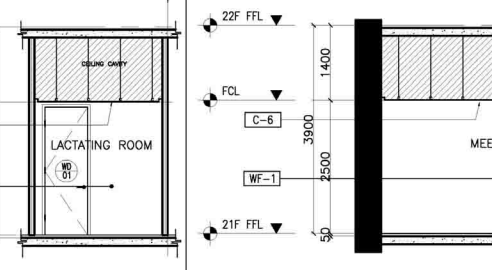
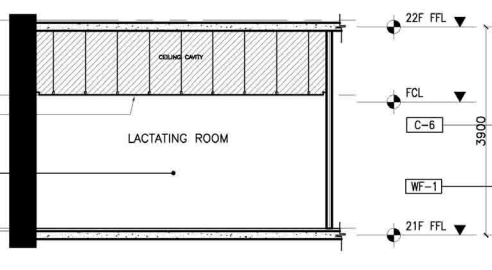
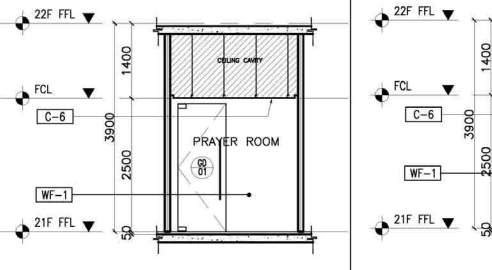
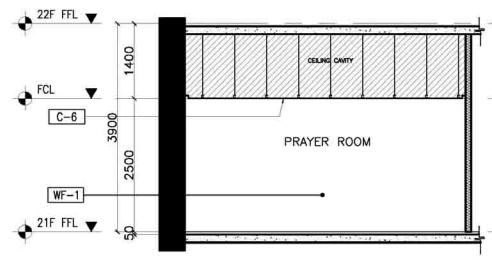
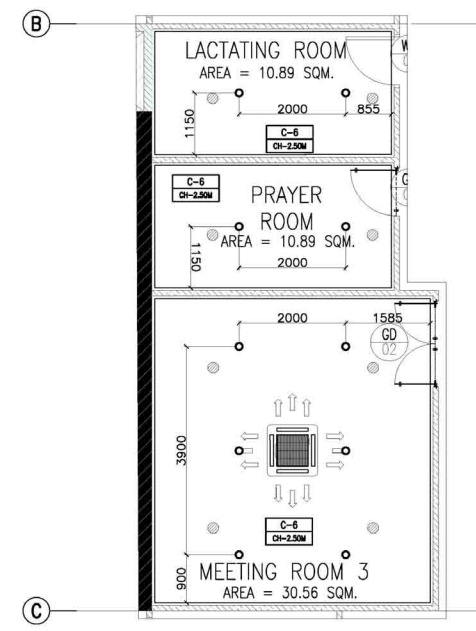
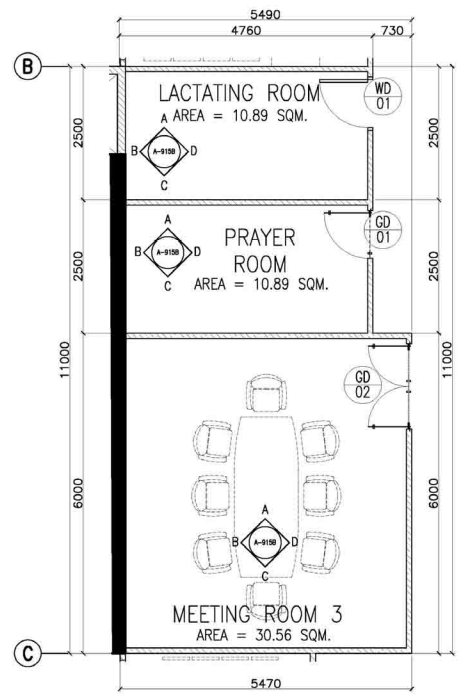
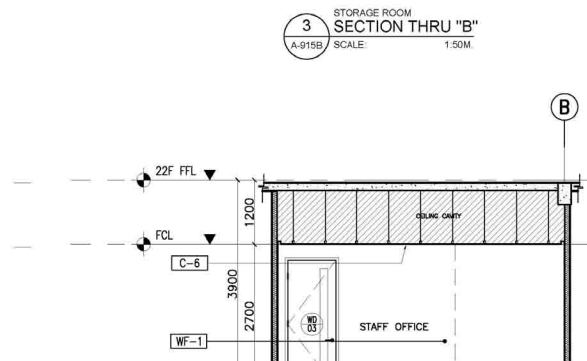
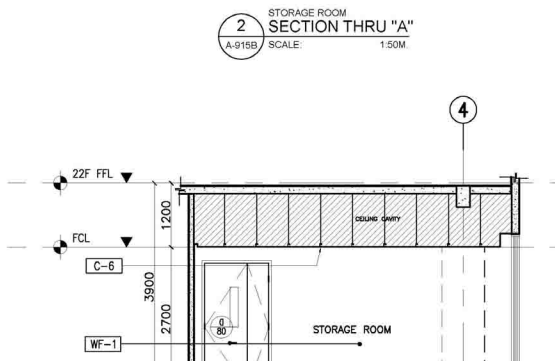
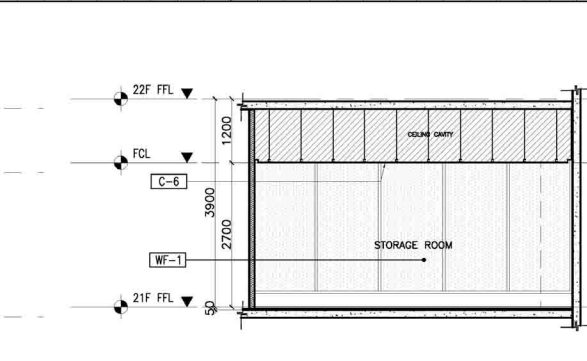
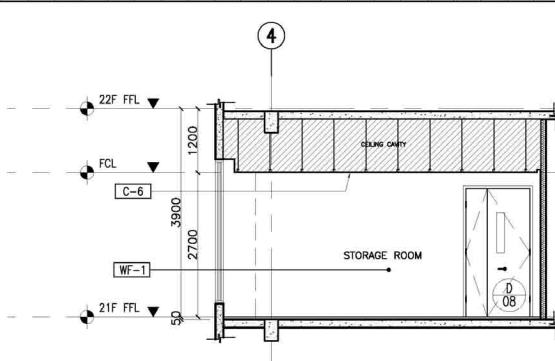
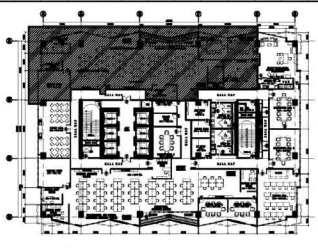

NOTE:
PURSUANT TO SECTION 4 OF ANNEX "A" OF THE REVISED IMPLEMENTING RULES AND REGULATIONS OF R.A. 9164, APPROVAL BY THE AUTHORIZED DPWH OFFICIALS OF DETAILED ENGINEERING SURVEYS AND DESIGN UNDERTAKEN BY CONSULTANTS NEITHER DIMINISHES THE RESPONSIBILITY OF THE ARCHITECT FOR THE TECHNICAL INTEGRITY OF THE SURVEYS AND DESIGN NOR TRANSFER ANY PART OF THAT RESPONSIBILITY TO THE APPROVING OFFICIALS.

THE DESIGN CONSULTANT SHALL BE HELD RESPONSIBLE FOR THE FAILURE OF THE FACILITY/IES / STRUCTURES DUE TO FAULTY DESIGN EXCEPT FOR THE CHANGES MADE WITHOUT THE CONFORMITY OF THE CONSULTANTS.

DRAWINGS AND SPECIFICATIONS DULY SIGNED, STAMPED OR SEALED, AS INSTRUMENTS OF SERVICE ARE PROPERTY AND DOCUMENTS OF THE ARCHITECT, WHETHER THE OBJECT FOR WHICH THEY ARE MADE IS EXECUTED OR NOT. IT SHALL BE UNLAWFUL FOR ANY PERSON, WITHOUT THE WRITTEN CONSENT OF THE ARCHITECT OR AUTHOR OF SAID DOCUMENTS, TO DUPLICATE OR TO MAKE COPIES OF SAID DOCUMENTS FOR USE IN THE REPEITION OF AND FOR OTHER PROJECTS OR BUILDINGS, WHETHER EXECUTED PARTLY OR IN WHOLE.



ENRIQUE O. OLANAN
ARCHITECT
PROJECT MANAGER
BUILDING & SPECIAL PROJECTS MANAGEMENT CLUSTER
UNIFIED PROJECT MANAGEMENT OFFICE, DPWH

JOSE MANUEL AGUILARDO
ARCHITECT
PROJECT DIRECTOR
BUILDING & SPECIAL PROJECTS MANAGEMENT CLUSTER
UNIFIED PROJECT MANAGEMENT OFFICE, DPWH

ATTY. JOHNSON V. DOMINCO
PROJECT DIRECTOR
BUILDING & SPECIAL PROJECTS MANAGEMENT CLUSTER
UNIFIED PROJECT MANAGEMENT OFFICE, DPWH

REYNOR R. IMPERIAL
DIRECTOR
PLANNING AND MANAGEMENT SERVICE
CO-HEAD, PSA-BCDM

SOCRATES L. RAMORRES
DIRECTOR
ASSISTANT NATIONAL STATISTICIAN
FINANCE AND ADMINISTRATIVE SERVICE
HEAD, PSA-BCDM

LEIO B. MALAGAR
DEPUTY NATIONAL STATISTICIAN
CIVIL REGISTRATION & GENERAL SUPPORT OFFICE

USBC CLAIRE DENNIS S. MAPA, PH.D.
NATIONAL STATISTICIAN AND CIVIL REGISTRAR GENERAL
PHILIPPINE STATISTICS AUTHORITY

CONSTRUCTION OF FIT-OUT AND LANDSCAPE WORKS FOR THE TWENTY-THREE (23) STOREY PHILIPPINE STATISTICS AUTHORITY (PSA) OFFICE BUILDING WITH COVERED ROOF DECK

PSA COMPLEX, EAST AVENUE, DILIMAN, QUEZON CITY

DESIGNER: E. OLANAN
EAD: AET / ADI
CHECKED: RIB / AET
DATE: MAY 2021

REVISIONS	SYMBOL	REMARK	DATE

SHEET NO. A-915B

LEGEND:

FLOOR FINISH LEGEND :

FLOOR FINISHES	
F-1	POLYURETHANE-BASED EPOXY FLOOR COATING
F-2	BARE STRUCTURAL CONCRETE SLAB DEPRESSED 50MM TO RECEIVE TOPPING AND FINISH
F-3	600mm x 600mm x 8mm THK NON-SKID FLOOR TILE
F-4	600mm x 600mm x 8mm THK POLISHED FLOOR TILE
F-5	EPOXY TANK LINING
F-6	CEMENT-BASED NON-SKID WAFFLE TILE
F-7	WET-INSTALLED 20mm THK FLAMED GRANITE SLAB (PROVIDE SEALER)
F-8	TROWEL FINISH WITH PENETRATING SEALER AND HARDENER
F-9	600mm x 600mm CARPET TILES
F-10	RUBBERIZED MAT FLOORING
F-11	SIMULATED WOOD TILES
F-12	600mm x 600mm x 10mm THK POLISHED GRANITE FLOOR TILE

PARTITION TYPE LEGEND :

FLOOR FINISHES	
P-1	125mm THK. CAST-IN-PLACE CONCRETE EXTERIOR WALL
P-2	REINFORCED STRUCTURAL CONCRETE WALL
P-3	150mm THK. CHB 2HR FIRE RATED (FLOOR TO BOTTOM SLAB/BEAM) PLASTERED AND FINISH AS PER WALL FINISHED SCHEDULE
P-4	150mm THK. CHB (FLOOR TO BOTTOM SLAB/BEAM) PLASTERED AND FINISH AS PER WALL FINISHED SCHEDULE
P-5a	100mm THK. FULL HT DRY WALL PARTITION w/ 2HR FIRE RATING. GYPSUM BOARD ON METAL FURRING PLASTERED AND FINISHED AS PER WALL FINISH SCHED.
P-5b	100mm THK. 1.8m HT DRY WALL PARTITION w/ 2HR FIRE RATING. GYPSUM BOARD ON METAL FURRING PLASTERED AND FINISHED AS PER WALL FINISH SCHED.
P-6	12mm THK CLEAR SEMI-FRAMELESS FULL HT TEMPERED GLASS WALL PARTITION w/ MID-HT FROSTED STICKER BAND

WALL FINISH LEGEND :

FLOOR FINISHES	
W-1	SEMI-GLOSS LATEX PAINT FINISH
W-2	300X600X25mm THK. POLISHED HOMOGENOUS WALL TILE
W-3	600X600X25mm THK. POLISHED HOMOGENOUS GRANITE WALL TILE
W-4	EPOXY LINING
W-5	LIQUID-APPLIED ELASTOMERIC WALL COATING
W-6	LIQUID-APPLIED ELASTOMERIC WALL COATING + DRY-INSTALLED GRANITE SLAB ON STAINLESS STEEL ANCHORS
W-7	PAINTED FINISH WITH TRAFFIC STRIPE PATTERN
W-8	DECORATIVE WALL STICKER ON SKIM COAT WALL COATING
W-9	ACOUSTIC PADDING

CEILING FINISHES LEGEND :

CEILING FINISHES	
C-1	LOW SHEEN ACRYLIC LATEX PAINT ON SMOOTH RUBBED FINISHED EXPOSED UNDERSIDE OF SLAB/ BEAM
C-2	LOW SHEEN ACRYLIC LATEX PAINT ON 12mm THK MOISTURE RESISTANT GYPSUM BOARD ON METAL CEILING JOIST
C-3	600X600 REGULAR ACOUSTIC TILES ON POWDER COATED ALUMINUM T RUNNERS
C-4	POWDER COATED ALUMINUM PANELS ON CONCEALED ALUMINUM RUNNERS
C-5	12mm THK. GYPSUM BOARD ON HPL METAL FIN. AND 6mm THK. GRAPHICOTE GLASS PANELS ON POWDER COATED ALUMINUM FRAMING WITH 6mm THK. ACRYLIC DIFFUSERS
C-6	LOW SHEEN ACRYLIC LATEX PAINT ON 12mm THK GYPSUM BOARD ON METAL CEILING JOIST
C-7	ALUMINUM COMPOSITE CEILING PANEL
C-8	LOW SHEEN ACRYLIC LATEX PAINT ON 12mm THK GYPSUM BOARD HEXAGONAL ACCENT DROP CEILING 120H DIA x 150mm THK ON METAL HANGERS.

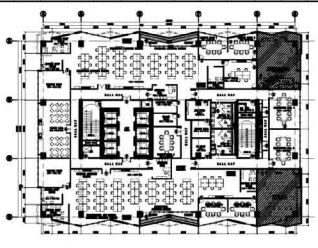

1 21ST FLOOR KEYPLAN
A-915C SCALE: 1:500M

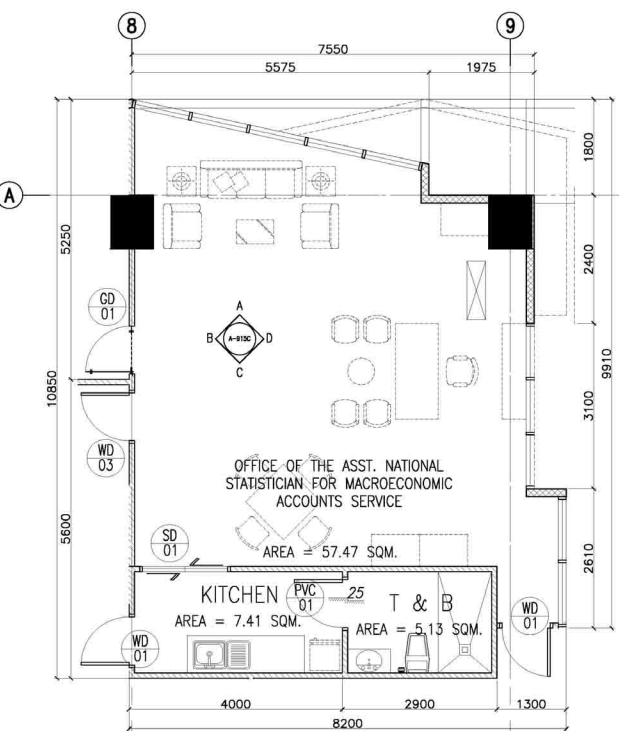

2 OFFICE OF THE ASST. NS BLOW UP PLAN
A-915C SCALE: 1:50M

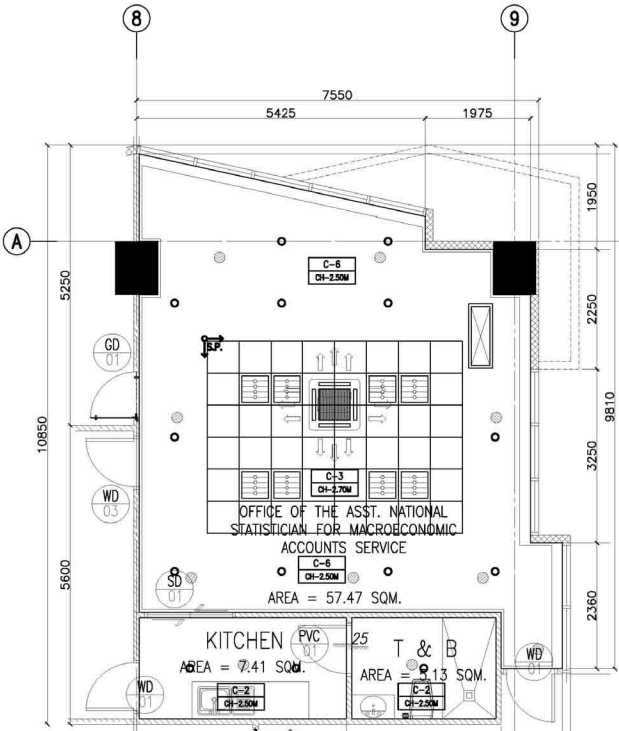

3 OFFICE OF THE ASST. NS REFLECTED CEILING PLAN
A-915C SCALE: 1:50M

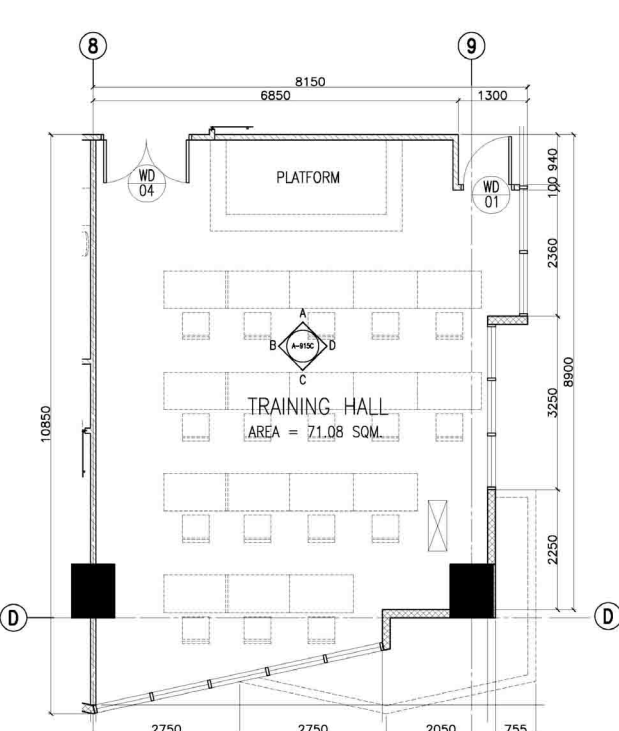

4 TRAINING HALL BLOW UP PLAN
A-915C SCALE: 1:50M

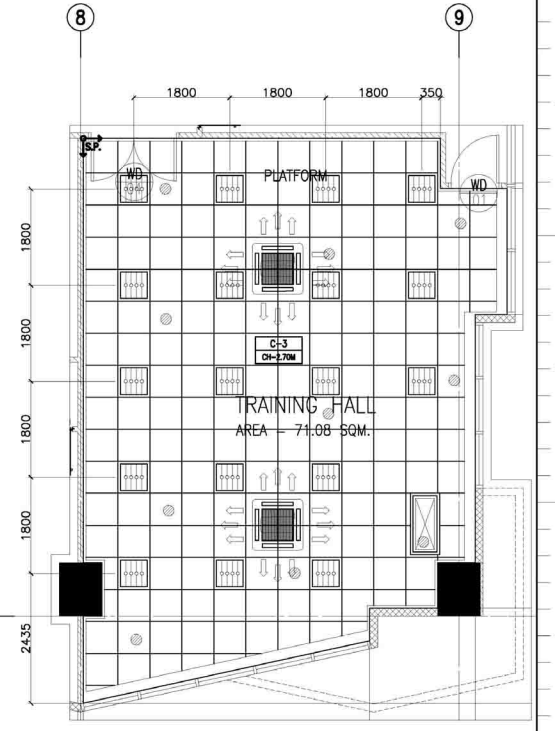

5 TRAINING HALL REFLECTED CEILING PLAN
A-915C SCALE: 1:50M

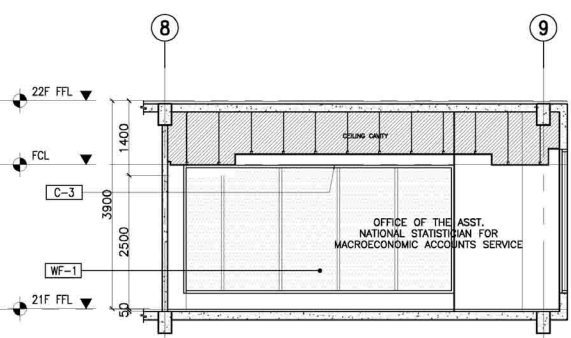

6 OFFICE OF THE ASST. NS SECTION THRU "A"
A-915C SCALE: 1:50M

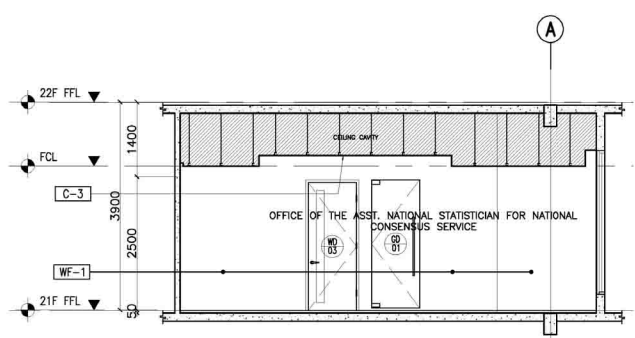

7 OFFICE OF THE ASST. NS SECTION THRU "B"
A-915C SCALE: 1:50M

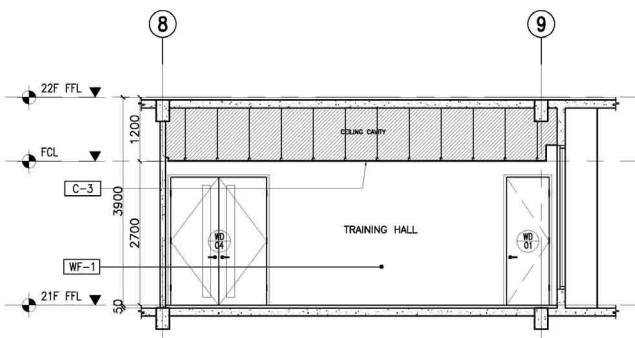

10 TRAINING HALL SECTION THRU "A"
A-915C SCALE: 1:50M

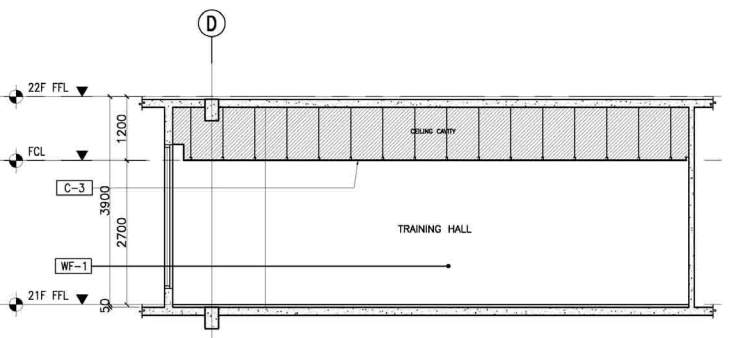

11 TRAINING HALL SECTION THRU "B"
A-915C SCALE: 1:50M

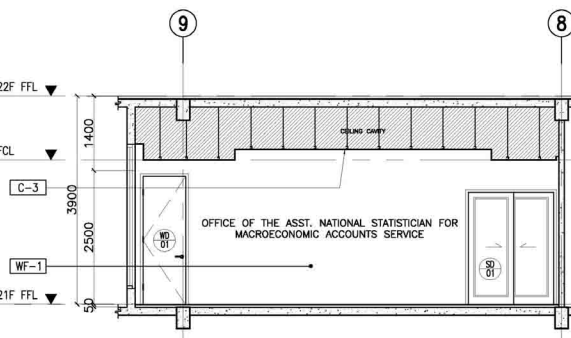

8 OFFICE OF THE ASST. NS SECTION THRU "C"
A-915C SCALE: 1:50M

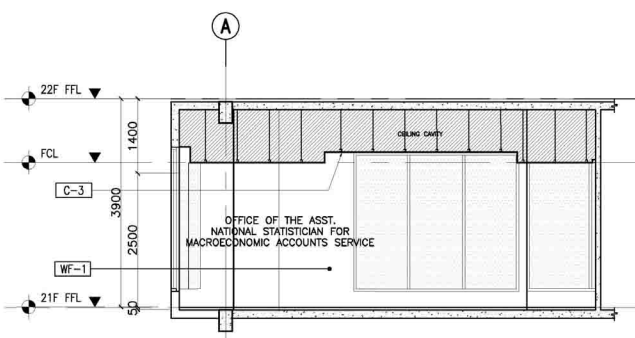

9 OFFICE OF THE ASST. NS SECTION THRU "D"
A-915C SCALE: 1:50M

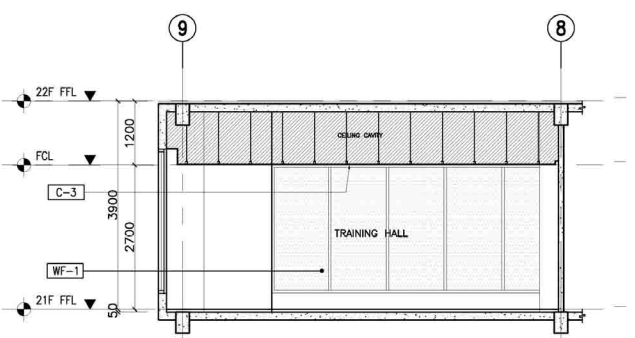

12 TRAINING HALL SECTION THRU "C"
A-915C SCALE: 1:50M

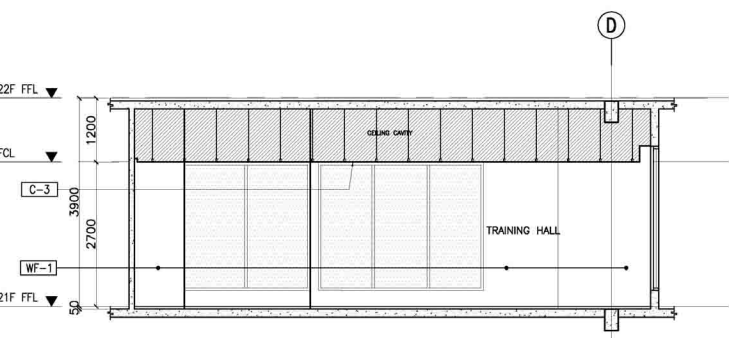

13 TRAINING HALL SECTION THRU "D"
A-915C SCALE: 1:50M

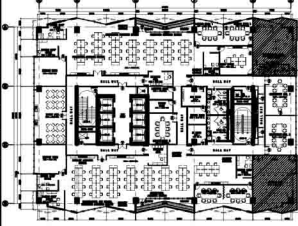

14 21ST FLOOR KEYPLAN
A-915C SCALE: 1:500M

NOTE:
PURSUANT TO SECTION 4 OF ANNEX "A" OF THE REVISED IMPLEMENTING RULES AND REGULATIONS OF R.A. 9164, APPROVAL BY THE AUTHORIZED DPWH OFFICIALS OF DETAILED ENGINEERING SURVEYS AND DESIGN UNDERTAKEN BY CONSULTANTS NEITHER TRANSFERS THE RESPONSIBILITY OF THE LATTER FOR THE TECHNICAL INTEGRITY OF THE SURVEYS AND DESIGN NOR TRANSFER ANY PART OF THAT RESPONSIBILITY TO THE APPROVING OFFICIALS.
THE DESIGN CONSULTANT SHALL BE HELD RESPONSIBLE FOR THE FAILURE OF THE FACILITY/IES / STRUCTURES DUE TO FAULTY DESIGN EXCEPT FOR THE CHANGES MADE WITHOUT THE CONFORMITY OF THE CONSULTANTS.

DRAWINGS AND SPECIFICATIONS DULY SIGNED, STAMPED OR SEALED, AS INSTRUMENTS OF SERVICE, ARE PROPERTY AND DOCUMENTS OF THE ARCHITECT, WHETHER THE OBJECT FOR WHICH THEY ARE MADE IS EXECUTED OR NOT. IT SHALL BE UNLAWFUL FOR ANY PERSON, WITHOUT THE WRITTEN CONSENT OF THE ARCHITECT OR AUTHOR OF SAID DOCUMENTS, TO DUPLICATE OR TO MAKE COPIES OF SAID DOCUMENTS FOR USE IN THE REPEITION OF AND FOR OTHER PROJECTS OR BUILDINGS, WHETHER EXECUTED PARTLY OR IN WHOLE.

<p>TC TOKWING CONSTRUCTION CORPORATION 4643 S. RIVERVIEW AVE. LAYUNGA HEIGHTS, QUEZON CITY TEL. NO. (02) 899 8058 Email: tokwingcorp@yaho.com.ph</p>	<p>ENRIQUE O. OLANAN & ASSOCIATES ARCHITECTS ENGINEERS CONSULTANTS Suite 303, Seaside Villa Square Condominiums, 463-38 Seaside Ave. Layuna Heights, Quezon City Tel. No. (02) 899 8058 Email: eolanan@enriquetolanan.com</p>	CONSULTANT:	CHECKED:	REVIEWED:	RECOMMENDING APPROVAL:	APPROVED:	PROJECT:	SHEET CONTENT:	DESIGNER:	REVISIONS:	SHEET NO.:		
		ENRIQUE O. OLANAN	JOSE MANUEL AGUILARDO	ATTY. JOHNSON V. DOMINCO	REYNOR R. IMPERIAL	LEO B. MALAGAR	USBC CLAIRE DENNIS S. MAPA, PH. D.	CONSTRUCTION OF FIT-OUT AND LANDSCAPE WORKS FOR THE TWENTY-THREE (23) STOREY PHILIPPINE STATISTICS AUTHORITY (PSA) OFFICE BUILDING WITH COVERED ROOF DECK	21ST FLOOR BLOW-UP DETAILS	E. OLANAN	SYMBOL	REMARK	DATE
		PROJECT MANAGER	PROJECT DIRECTOR	DIRECTOR OF BUILDING & SPECIAL PROJECTS MANAGEMENT CLUSTER	CO-HEAD, PSA-BOCM	ASSISTANT SECRETARY DEPUTY NATIONAL STATISTICIAN	NATIONAL STATISTICIAN AND CIVIL REGISTRAR GENERAL			RIB / AET			A-915C
		DATE: 04/09/2023	DATE: 01/20/2022	DATE: 01/20/2022	DATE: 01/20/2022	DATE: 01/20/2022	DATE: 01/20/2022	LOCATION: PSA COMPLEX, EAST AVENUE, DILIMAN, QUEZON CITY			MAY 2021		