

FLOOR FINISH LEGEND :

NEW FINISHES	
F-1	BARE STRUCTURAL CONCRETE SLAB DEPRESSED 50MM TO RECEIVE TOPPING AND FINISH
F-2	600mm x 600mm CARPET TILES
F-3	600mm x 600mm x 8mm THK NON-SKID FLOOR TILE
F-4	600mm x 600mm x 8mm THK POLISHED FLOOR TILE
F-5	RUBBERIZED MAT FLOORING
F-6	SHIMULATED WOOD TILES
F-7	600mm x 600mm x 10mm THK POLISHED GRANITE FLOOR TILE
EXISTING FINISHES	
EX-01	POLYURETHANE-BASED EPOXY FLOOR COATING
EX-02	EPOXY TANK LINING
EX-03	CEMENT-BASED NON-SKID WAFFLE TILE
EX-04	WET-INSTALLED 20mm THK FLAMED GRANITE SLAB (PROVIDE SEALER)
EX-05	TROWEL FINISH WITH PENETRATING SEALER AND HARDENER
EX-06	600mm x 600mm x 8mm THK NON-SKID FLOOR TILE
EX-07	600mm x 600mm x 10mm THK POLISHED GRANITE FLOOR TILE
EX-08	600mm x 600mm x 8mm THK POLISHED FLOOR TILE

CEILING FINISHES LEGEND :

NEW FINISHES	
C-1	LOW SHEEN ACRYLIC LATEX PAINT ON SMOOTH RUBBED FINISHED EXPOSED UNDERSIDE OF SLAB/BEAM
C-2	LOW SHEEN ACRYLIC LATEX PAINT ON 12mm THK MOISTURE RESISTANT GYPSUM BOARD ON METAL CEILING JOIST
C-3	600x600 REGULAR ACOUSTIC TILES ON POWDER COATED ALUMINUM T RUNNERS
C-4	POWDER COATED ALUMINUM PANELS ON CONCEALED ALUMINUM RUNNERS
C-5	12mm THK GYPSUM BOARD IN HPL METAL FIN. AND 6mm THK GRAPHICOTE GLASS PANELS ON POWDER COATED ALUMINUM FRAMING WITH 6mm THK ACRYLIC DIFFUSERS
C-6	LOW SHEEN ACRYLIC LATEX PAINT ON 12mm THK GYPSUM BOARD ON METAL CEILING JOIST
C-7	ALUMINUM COMPOSITE CEILING PANEL
C-8	LOW SHEEN ACRYLIC LATEX PAINT ON 12mm THK GYPSUM BOARD HEXAGONAL ACCENT DROP CEILING 1.20m DIA x 150mm THK ON METAL HANGERS
EXISTING FINISHES	
EX-C-1	LOW SHEEN ACRYLIC LATEX PAINT ON SMOOTH RUBBED FINISHED EXPOSED UNDERSIDE OF SLAB/BEAM
EX-C-2	LOW SHEEN ACRYLIC LATEX PAINT ON 12mm THK MOISTURE RESISTANT GYPSUM BOARD ON METAL CEILING JOIST
EX-C-3	LOW SHEEN ACRYLIC LATEX PAINT ON 12mm THK GYPSUM BOARD ON METAL CEILING JOIST

WALL FINISH LEGEND :

EXISTING FINISHES	
EXW-1	SEMI-GLOSS LATEX PAINT FINISH
EXW-2	300x600x25mm THK. POLISHED HOMOGENOUS WALL TILE
EXW-3	EPOXY LINING
EXW-4	LIQUID-APPLIED ELASTOMERIC WALL COATING
EXW-5	PAINTED FINISH WITH TRAFFIC STRIPE PATTERN
NEW FINISHES	
WF-1	SEMI-GLOSS LATEX PAINT FINISH
WF-2	300x600x25mm THK. POLISHED HOMOGENOUS WALL TILE
WF-3	SKIM COAT WALL COATING FINISH
WF-4	ACOUSTIC PADDING
WF-5	6mm THK. COLOR COATED GLASS
WF-6	WOOD VENEER (VERIFY DESIGN ON DETAILS)

PARTITION TYPE LEGEND :

EXISTING PARTITION	
EXP-1	125mm THK. CAST-IN-PLACE CONCRETE EXTERIOR WALL
EXP-2	REINFORCED STRUCTURAL CONCRETE WALL
EXP-3	150mm THK. CHB (FLOOR TO FLOOR TO BOTTOM SLAB/BEAM) PLASTERED AND FINISH AS PER WALL FINISHED SCHEDULE
EXP-4	150mm THK. CHB (FLOOR TO BOTTOM SLAB/BEAM) PLASTERED AND FINISH AS PER WALL FINISHED SCHEDULE
NEW PARTITION	
P-1	150mm THK. CHB (FLOOR TO BOTTOM SLAB/BEAM) PLASTERED AND FINISH AS PER WALL FINISHED SCHEDULE
P-2	100mm THK. FULL HT DRY WALL PARTITION w/ 2HR FIRE RATING, GYPSUM BOARD ON METAL FURRING PLASTERED AND FINISHED AS PER WALL FINISH SCHED.
P-3	100mm THK. 1.8m HT DRY WALL PARTITION w/ 2HR FIRE RATING, GYPSUM BOARD ON METAL FURRING PLASTERED AND FINISHED AS PER WALL FINISH SCHED.
P-4	100mm THK. DRY WALL CLADDING IN 200MM ABOVE FINISH FLOOR LINE (SEE INTERIOR DETAILS)
P-5	12mm THK CLEAR SEMI-FRAMELESS FULL HT TEMPERED GLASS WALL PARTITION w/ MID-HT FROSTED STICKER BAND

NOTE:
PURSUANT TO SECTION 4 OF ANNEX "A" OF THE REVISED IMPLEMENTING RULES AND REGULATIONS OF R.A. 9164, APPROVAL BY THE AUTHORIZED DPWH OFFICIALS OF DETAILED ENGINEERING SURVEYS AND DESIGN UNDERTAKEN BY CONSULTANTS NEITHER DIMINISHES THE RESPONSIBILITY OF THE LATTER FOR THE TECHNICAL INTEGRITY OF THE SURVEYS AND DESIGN NOR TRANSFER ANY PART OF THAT RESPONSIBILITY TO THE APPROVING OFFICIALS.
THE DESIGN CONSULTANT SHALL BE HELD RESPONSIBLE FOR THE FAILURE OF THE FACILITY/IES / STRUCTURES DUE TO FAULTY DESIGN EXCEPT FOR THE CHANGES MADE WITHOUT THE CONFORMITY OF THE CONSULTANTS.

DRAWINGS AND SPECIFICATIONS DULY SIGNED, STAMPED OR SEALED, AS INSTRUMENTS OF SERVICE ARE PROPERTY AND DOCUMENTS OF THE ARCHITECT, WHETHER THE OBJECT FOR WHICH THEY ARE MADE IS EXECUTED OR NOT. IT SHALL BE UNLAWFUL FOR ANY PERSON, WITHOUT THE WRITTEN CONSENT OF THE ARCHITECT OR AUTHOR OF SAID DOCUMENTS, TO DUPLICATE OR TO MAKE COPIES OF SAID DOCUMENTS FOR USE IN THE REPEITION OF AND FOR OTHER PROJECTS OR BUILDINGS, WHETHER EXECUTED PARTLY OR IN WHOLE.

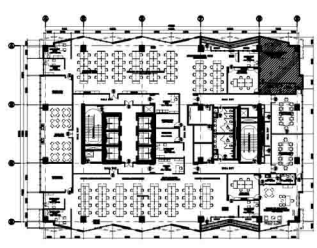

1 19TH FLOOR KEYPLAN
SCALE: 1:500M

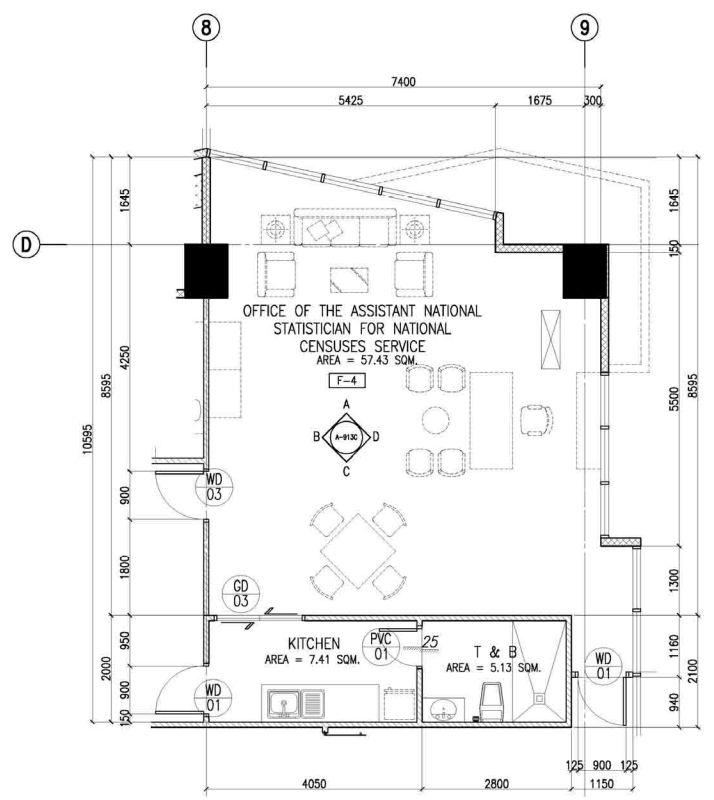

2 19F ANS NCS OFFICE BLOW-UP PLAN
SCALE: 1:50M

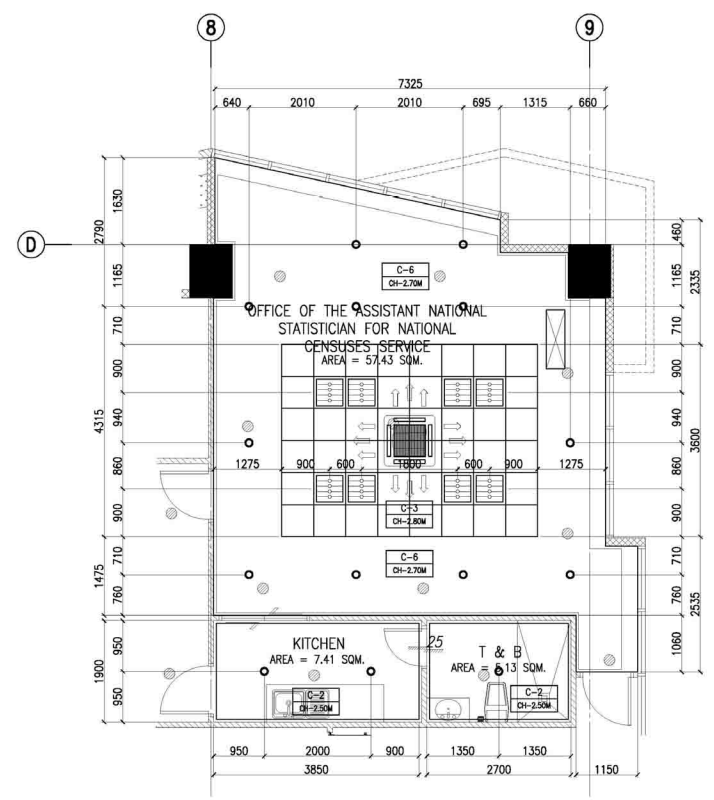

3 19F ANS NCS OFFICE REFLECTED CEILING PLAN
SCALE: 1:50M

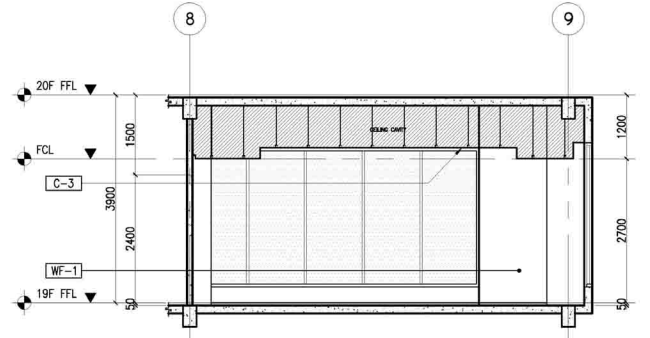

4 19F ANS NCS OFFICE SECTION THRU "A"
SCALE: 1:50M

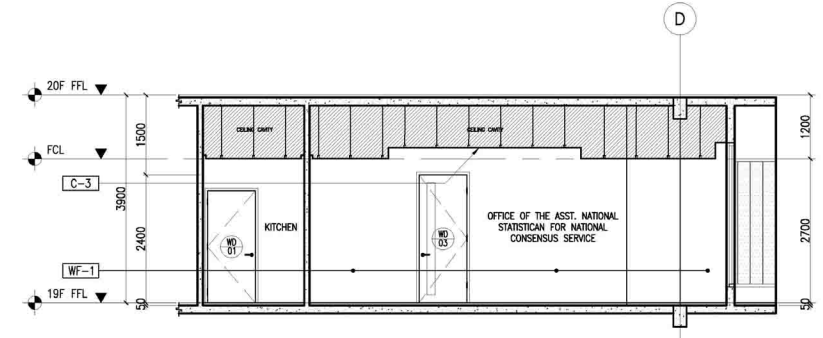

5 19F ANS NCS OFFICE SECTION THRU "B"
SCALE: 1:50M

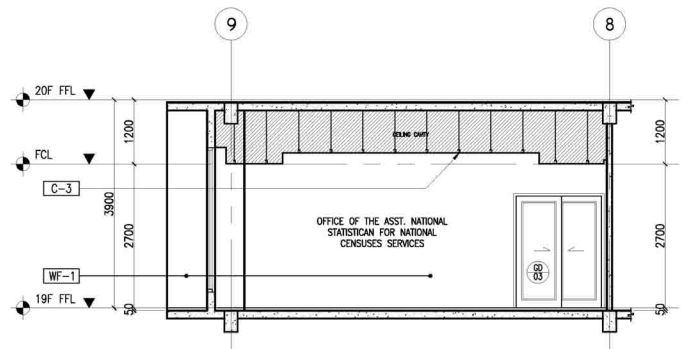

6 19F ANS NCS OFFICE SECTION THRU "C"
SCALE: 1:50M

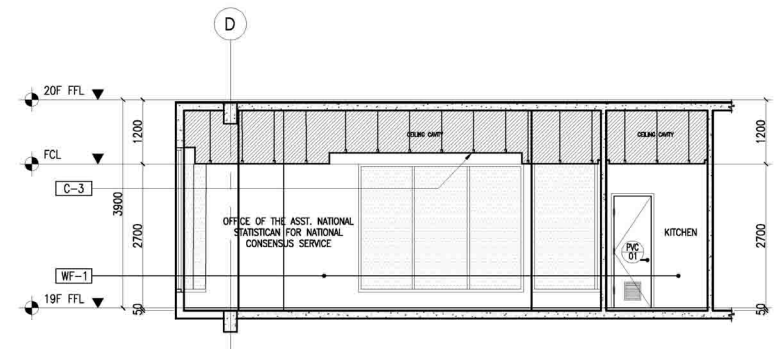

7 19F ANS NCS OFFICE SECTION THRU "D"
SCALE: 1:50M

TOKWING CONSTRUCTION CORPORATION
ENRICO O. OLANON & ASSOCIATES

ENRIQUE O. OLANON
ARCHITECTS ENGINEERS CONSULTANTS

CONSULTANT: ENRIQUE O. OLANON
CHECKED: JOSE MANUEL AGUILARDO

REVIEWED: ATTY. JOHNSON V. DOMINCO
RECOMMENDING APPROVAL: REYNOR B. IMPERIAL

APPROVED: SOCORATE L. RAMORRES
LEO B. MALAGAR

PROJECT: CONSTRUCTION OF FIT-OUT AND LANDSCAPE WORKS FOR THE TWENTY-THREE (23) STOREY PHILIPPINE STATISTICS AUTHORITY (PSA) OFFICE BUILDING WITH COVERED ROOF DECK

DESIGNER: E. OLANON
CAD: AET / ADI
CHECKED: RIB / AET
DATE: MAY 2021

REVISIONS: SYMBOL, REMARK, DATE

SHEET CONTENT: 19TH FLOOR BLOW-UP DETAILS

PROJECT LOCATION: PSA COMPLEX, EAST AVENUE, DILIMAN, QUEZON CITY

DESIGNER: E. OLANON
CAD: AET / ADI
CHECKED: RIB / AET
DATE: MAY 2021

REVISIONS: SYMBOL, REMARK, DATE

SHEET NO.: A-913C

FLOOR FINISH LEGEND :

NEW FINISHES

F-1 BARE STRUCTURAL CONCRETE SLAB DEPRESSED 50mm TO RECEIVE TOPPING AND FINISH

F-2 600mm x 600mm CARPET TILES

F-3 600mm x 600mm x 8mm THK NON-SKID FLOOR TILE

F-4 600mm x 600mm x 10mm THK POLISHED FLOOR TILE

F-5 RUBBERIZED MAT FLOORING

F-6 SIMULATED WOOD TILES

F-7 600mm x 600mm x 10mm THK POLISHED GRANITE FLOOR TILE

EXISTING FINISHES

EX-01 POLYURETHANE-BASED EPOXY FLOOR COATING

EX-02 EPOXY TANK LINING

EX-03 CEMENT-BASED NON-SKID WAFFLE TILE

EX-04 WET-INSTALLED 20mm THK FLAMED GRANITE SLAB (PROVIDE SEALER)

EX-05 TROWEL FINISH WITH PENETRATING SEALER AND HARDENER

EX-06 600mm x 600mm x 8mm THK NON-SKID FLOOR TILE

EX-07 600mm x 600mm x 10mm THK POLISHED GRANITE FLOOR TILE

EX-08 600mm x 600mm x 8mm THK POLISHED FLOOR TILE

CEILING FINISHES LEGEND :

NEW FINISHES

C-1 LOW SHEEN ACRYLIC LATEX PAINT ON SMOOTH RUBBED FINISHED EXPOSED UNDERSIDE OF SLAB/BEAM

C-2 LOW SHEEN ACRYLIC LATEX PAINT ON 12mm THK MOISTURE RESISTANT GYPSUM BOARD ON METAL CEILING JOIST

C-3 600x600 REGULAR ACOUSTIC TILES ON POWDER COATED ALUMINUM T RUNNERS

C-4 POWDER COATED ALUMINUM PANELS ON CONCEALED ALUMINUM RUNNERS

C-5 12mm THK GYPSUM BOARD IN HPL METAL FIN. AND 6mm THK GRAPHICITE GLASS PANELS ON POWDER COATED ALUMINUM FRAMING WITH 6mm THK ACRYLIC DIFFUSERS

C-6 LOW SHEEN ACRYLIC LATEX PAINT ON 12mm THK GYPSUM BOARD ON METAL CEILING JOIST

C-7 ALUMINUM COMPOSITE CEILING PANEL

C-8 LOW SHEEN ACRYLIC LATEX PAINT ON 12mm THK GYPSUM BOARD HEXAGONAL ACCENT DROP CEILING 1.20m DIA x 150mm THK ON METAL HANGERS

EXISTING FINISHES

EX-C-1 LOW SHEEN ACRYLIC LATEX PAINT ON SMOOTH RUBBED FINISHED EXPOSED UNDERSIDE OF SLAB/BEAM

EX-C-2 LOW SHEEN ACRYLIC LATEX PAINT ON 12mm THK MOISTURE RESISTANT GYPSUM BOARD ON METAL CEILING JOIST

EX-C-3 LOW SHEEN ACRYLIC LATEX PAINT ON 12mm THK GYPSUM BOARD ON METAL CEILING JOIST

WALL FINISH LEGEND :

EXISTING FINISHES

EX-W-1 SEMI-GLOSS LATEX PAINT FINISH

EX-W-2 300x600x25mm THK POLISHED HOMOGENOUS WALL TILE

EX-W-3 EPOXY LINING

EX-W-4 LIQUID-APPLIED ELASTOMERIC WALL COATING

EX-W-5 PAINTED FINISH WITH TRAFFIC STRIPE PATTERN

NEW FINISHES

WF-1 SEMI-GLOSS LATEX PAINT FINISH

WF-2 300x600x25mm THK POLISHED HOMOGENOUS WALL TILE

WF-3 SKIM COAT WALL COATING FINISH

WF-4 ACOUSTIC PADDING

WF-5 4mm THK COLOR COATED GLASS

WF-6 WOOD VENEER (VERIFY DESIGN ON DETAILS)

PARTITION TYPE LEGEND :

EXISTING PARTITION

EXP-1 125mm THK CAST-IN-PLACE CONCRETE EXTERIOR WALL

EXP-2 REINFORCED STRUCTURAL CONCRETE WALL

EXP-3 150mm THK CHB (FLOOR TO FLOOR TO BOTTOM SLAB/BEAM) PLASTERED AND FINISH AS PER WALL FINISHED SCHEDULE

EXP-4 150mm THK CHB (FLOOR TO 100 (LOW SLAB/BEAM) PLASTERED AND FINISH AS PER WALL FINISHED SCHEDULE

NEW PARTITION

P-1 150mm THK CHB (FLOOR TO BOTTOM SLAB/BEAM) PLASTERED AND FINISH AS PER WALL FINISHED SCHEDULE

P-2 100mm THK FULL HT DRY WALL PARTITION w/ 2HR FIRE RATING, GYPSUM BOARD ON METAL FURRING PLASTERED AND FINISHED AS PER WALL FINISH SCHED.

P-3 100mm THK 1.8m HT DRY WALL PARTITION w/ 2HR FIRE RATING, GYPSUM BOARD ON METAL FURRING PLASTERED AND FINISHED AS PER WALL FINISH SCHED.

P-4 100mm THK DRY WALL CLADDING IN 200mm ABOVE FINISH FLOOR LINE (SEE INTERIOR DETAILS)

P-5 12mm THK CLEAR SEMI-FRAMELESS FULL HT TEMPERED GLASS WALL PARTITION w/ MID-HT FROSTED STICKER BAND

NOTE:

PURSUANT TO SECTION 4 OF ANNEX "A" OF THE REVISED IMPLEMENTING RULES AND REGULATION OF R.A. 9164, APPROVAL BY THE AUTHORIZED DPWH OFFICIALS OF DETAILED ENGINEERING SURVEYS AND DESIGN UNDERTAKEN BY CONSULTANTS NEITHER DIMINISHES THE RESPONSIBILITY OF THE LATTER FOR THE TECHNICAL INTEGRITY OF THE SURVEYS AND DESIGN NOR TRANSFER ANY PART OF THAT RESPONSIBILITY TO THE APPROVING OFFICIALS.

THE DESIGN CONSULTANT SHALL BE HELD RESPONSIBLE FOR THE FAILURE OF THE FACILITY/IES / STRUCTURES DUE TO FAULTY DESIGN EXCEPT FOR THE CHANGES MADE WITHOUT THE CONFORMITY OF THE CONSULTANTS.

DRAWINGS AND SPECIFICATIONS DULY SIGNED, STAMPED OR SEALED AS INSTRUMENTS OF SERVICE ARE PROPERTY AND DOCUMENTS OF THE ARCHITECT, WHETHER THE OBJECT FOR WHICH THEY ARE MADE IS EXECUTED OR NOT. IT SHALL BE UNLAWFUL FOR ANY PERSON, WITHOUT THE WRITTEN CONSENT OF THE ARCHITECT OR AUTHOR OF SAID DOCUMENTS, TO DUPLICATE OR TO MAKE COPIES OF SAID DOCUMENTS FOR USE IN THE REPEITION OF AND FOR OTHER PROJECTS OR BUILDINGS, WHETHER EXECUTED PARTLY OR IN WHOLE.

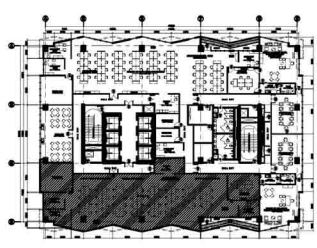

1 19TH FLOOR KEYPLAN
A-913D SCALE: 1:500M

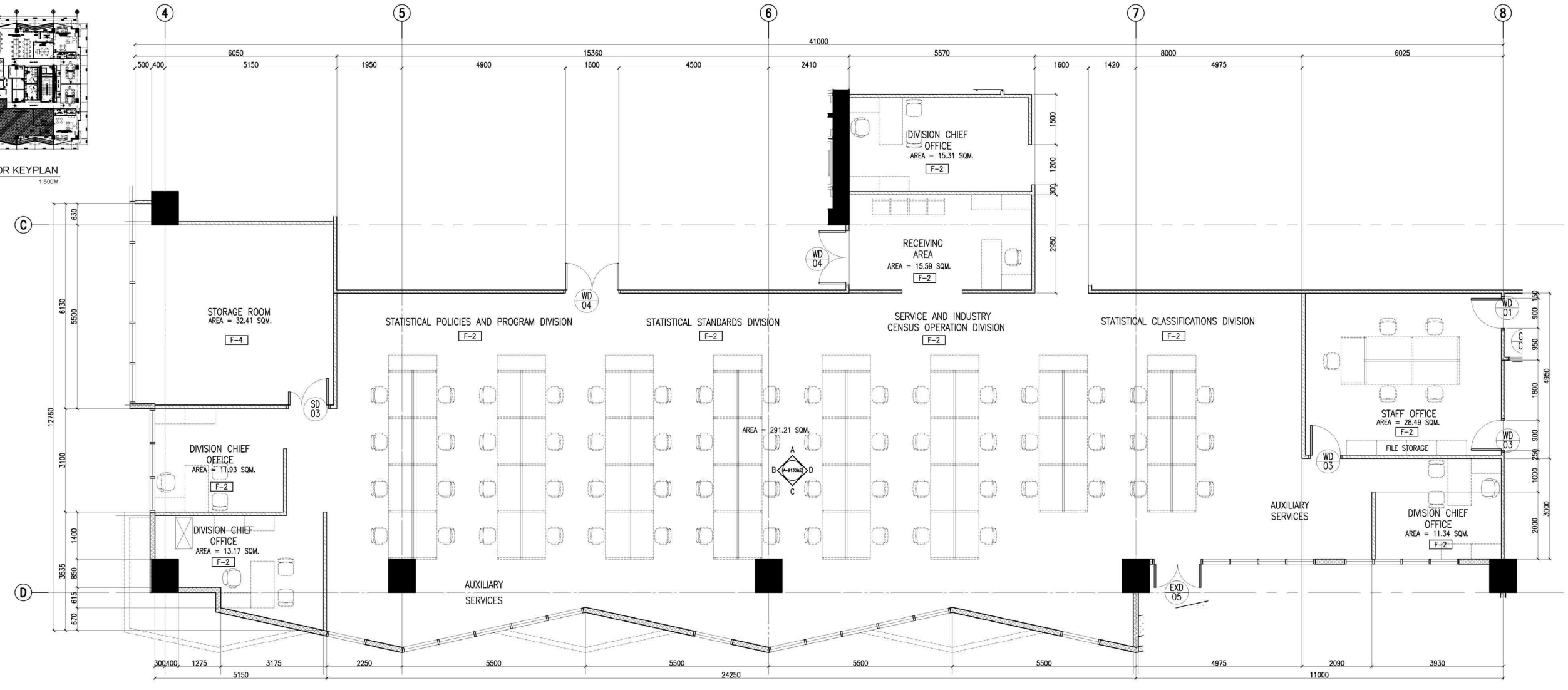

2 19F SFPD, SSD, SSI/OOD, SCD OFFICE BLOW-UP PLAN
A-913D SCALE: 1:50M

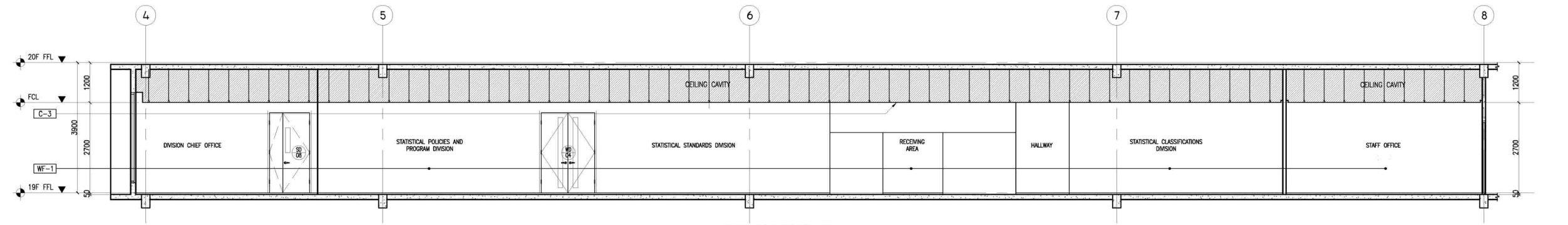

3 19F SFPD, SSD, SSI/OOD, SCD OFFICE SECTION THRU "A"
A-913D SCALE: 1:50M

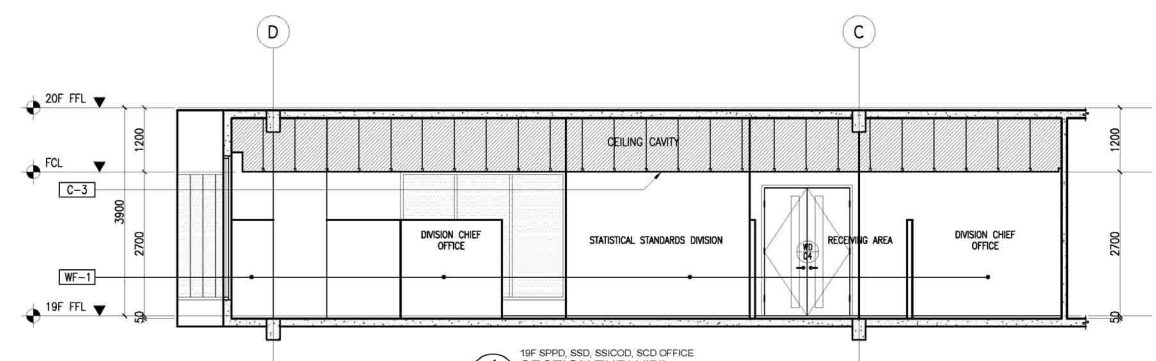

4 19F SFPD, SSD, SSI/OOD, SCD OFFICE SECTION THRU "B"
A-913D SCALE: 1:50M



CONSULTANT:	ENRIQUE O. OLANAN
PROJECT MANAGER:	JOSIE MANUEL AGUILARDO
PROJECT DIRECTOR:	ATTY. JOHNSON V. DOMINCO
PROJECT MANAGER II:	REYNOR B. IMPERIAL
PROJECT MANAGER III:	SOCRATES L. RAMORRES
PROJECT MANAGER IV:	LEO B. MALAGAR
PROJECT MANAGER V:	USOC CLAIRE DENNIS B. MAPA, PH. D.

CHECKED:	ENRIQUE O. OLANAN
DATE:	04/29/2023
PROJECT:	BUILDING & SPECIAL PROJECTS MANAGEMENT CLUSTER UNIFIED PROJECT MANAGEMENT OFFICE, DPWH

REVIEWED:	ATTY. JOHNSON V. DOMINCO
DATE:	01/20/2022
PROJECT:	BUILDING & SPECIAL PROJECTS MANAGEMENT CLUSTER UNIFIED PROJECT MANAGEMENT OFFICE, DPWH

RECOMMENDING APPROVAL:	REYNOR B. IMPERIAL
DATE:	01/20/2022
PROJECT:	PLANNING AND MANAGEMENT SERVICE CO-HEAD, PSA-BOON

APPROVED:	SOCRATES L. RAMORRES
DATE:	01/20/2022
PROJECT:	ASSISTANT NATIONAL STATISTICIAN FINANCE AND ADMINISTRATIVE SERVICE HEAD, PSA-BOON

APPROVED:	LEO B. MALAGAR
DATE:	01/20/2022
PROJECT:	ASSISTANT SECRETARY DEPUTY NATIONAL STATISTICIAN CIVIL REGISTRATION & GENERAL SUPPORT OFFICE HEAD, PSA-BOON

APPROVED:	USOC CLAIRE DENNIS B. MAPA, PH. D.
DATE:	01/20/2022
PROJECT:	NATIONAL STATISTICS AND CIVIL REGISTRATION GENERAL PHILIPPINE STATISTICS AUTHORITY

PROJECT:	CONSTRUCTION OF FIT-OUT AND LANDSCAPE WORKS FOR THE TWENTY-THREE (23) STOREY PHILIPPINE STATISTICS AUTHORITY (PSA) OFFICE BUILDING WITH COVERED ROOF DECK
LOCATION:	PSA COMPLEX, EAST AVENUE, DILIMAN, QUEZON CITY

SHEET CONTENT:	19TH FLOOR BLOW-UP DETAILS
----------------	----------------------------

DESIGNER:	E. OLANAN	REVISIONS:	SYMBOL	REMARK	DATE
CAD:	AET / ADI				
CHECKED:	RIB / AET				
DATE:	MAY 2021				

SHEET NO. A-913D