

NOTE:
PURSUANT TO SECTION 4 OF ANNEX "A" OF THE REVISED IMPLEMENTING RULES AND REGULATIONS OF RA 9184, APPROVAL BY THE AUTHORIZED DPWH OFFICIALS OF DETAILED ENGINEERING SURVEYS AND DESIGN UNDERTAKEN BY CONSULTANTS NEITHER DIMINISHES THE RESPONSIBILITY OF THE LETTER FOR THE TECHNICAL INTEGRITY OF THE SERVICES AND DESIGN NOR TRANSFER ANY PART OF THAT RESPONSIBILITY TO THE APPROVING OFFICIALS.

THE DESIGN CONSULTANT SHALL BE HELD RESPONSIBLE FOR THE FAILURE OF THE FACILITY/ES / STRUCTURES DUE TO FAULTY DESIGN EXCEPT FOR THE CHANGES MADE WITHOUT THE CONFORMITY OF THE CONSULTANTS.

DRAWINGS AND SPECIFICATIONS DULY SIGNED, STAMPED OR SEALED, AS INSTRUMENTS OF SERVICE, ARE PROPERTY AND DOCUMENTS OF THE ARCHITECT, WHETHER THE OBJECT FOR WHICH THEY ARE MADE IS EXECUTED OR NOT. IT SHALL BE UNLAWFUL FOR ANY PERSON, WITHOUT THE WRITTEN CONSENT OF THE ARCHITECT OR AUTHOR OF SAID DOCUMENTS, TO DUPLICATE OR TO MAKE COPIES OF SAID DOCUMENTS FOR USE IN THE REPEITION OF AND FOR OTHER PROJECTS OR BUILDINGS, WHETHER EXECUTED PARTLY OR IN WHOLE.

1 BASEMENT FLOOR SANITARY LAYOUT
S-01 SCALE 1:100 MTRS.

		CONSULTANT:	CESARI L. MADRUGA SANITARY ENGINEER	CHECKED:	JOSIE MANUEL AGUIBALDO PROJECT MANAGER III	REVIEWED:	ATTY. JOHNSON V. DOMINGO PROJECT DIRECTOR	RECOMMENDING APPROVAL:	REYNOR P. IMPERIAL DIRECTOR III PLANNING AND MANAGEMENT SERVICE CO-HEAD, PSA-BOCM	APPROVED:	SOCRATES L. RAMONER ASSISTANT NATIONAL STATISTICIAN FINANCE AND ADMINISTRATIVE SERVICE HEAD, PSA-BOCM	LEO B. MALACAP ASSISTANT SECRETARY DEPUTY NATIONAL STATISTICIAN CIVIL REGISTRATION & CENTRAL SUPPORT OFFICE	USEC. CLAIRE DENNIS S. MAHA, PH. D. NATIONAL STATISTICIAN AND CIVIL REGISTRAR GENERAL PHILIPPINE STATISTICS AUTHORITY	PROJECT:	CONSTRUCTION OF FIT-OUT AND LANDSCAPE WORKS FOR THE TWENTY-THREE (23) STOREY PHILIPPINE STATISTICS AUTHORITY (PSA) OFFICE BUILDING WITH COVERED ROOF DECK	SHEET CONTENT:	BASEMENT FLOOR SANITARY LAYOUT	DESIGNER:	E. OLANAN	REVISIONS:		SHEET NO.:	S-01
		DATE:	MAY 2021	SYMBOL:		REMARK:		DATE:															

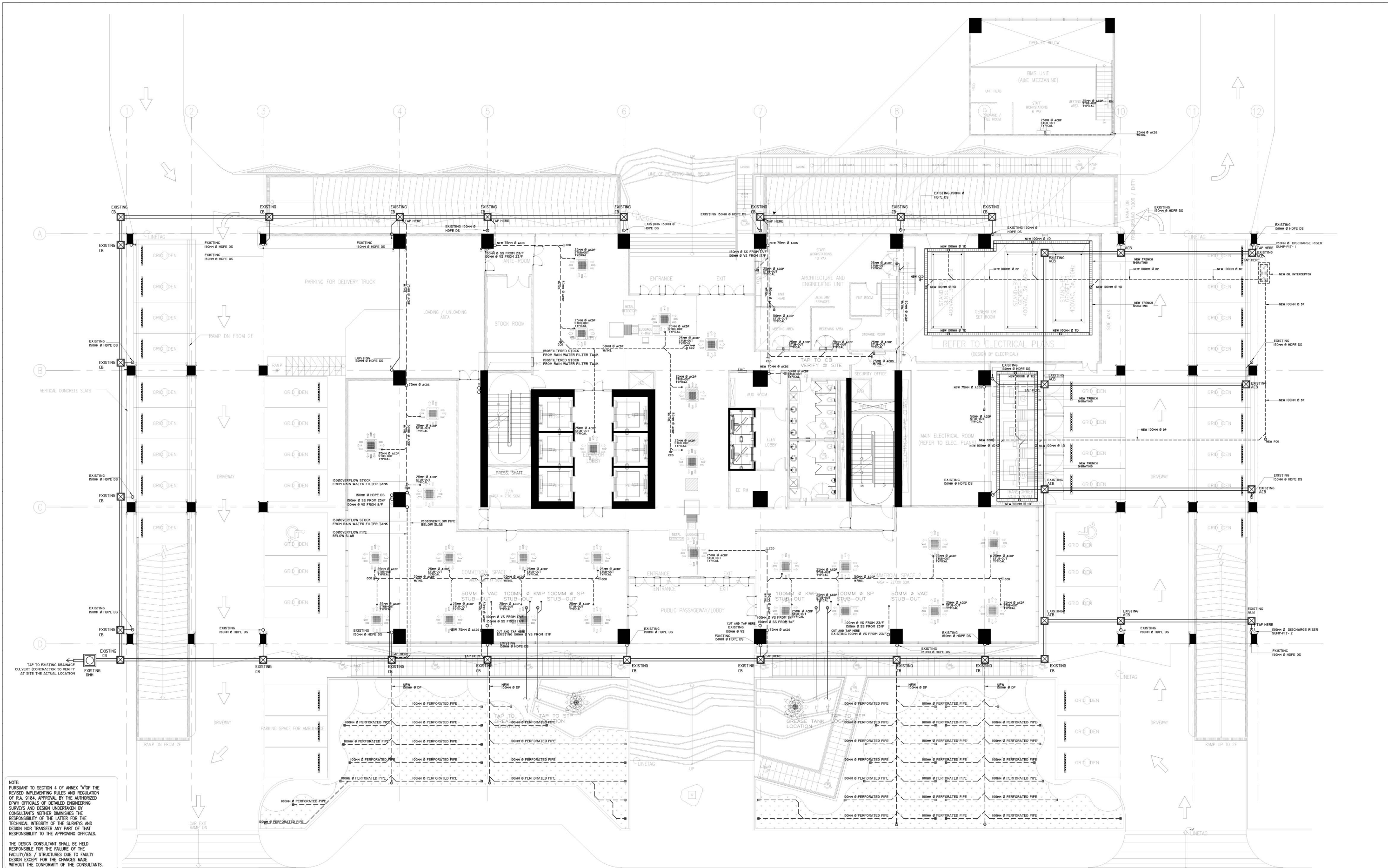

1 GROUND FLOOR SANITARY LAYOUT EAST AVENUE
 S-02 SCALE 1:100 MTRS.

NOTE:
 PURSUANT TO SECTION 4 OF ANNEX "A" OF THE REVISED IMPLEMENTING RULES AND REGULATION OF RA 9184, APPROVAL BY THE AUTHORIZED DPWH OFFICIALS OF DETAILED ENGINEERING SURVEYS AND DESIGN UNDERTAKEN BY CONSULTANTS NEITHER DIMINISHES THE RESPONSIBILITY OF THE LATTER FOR THE TECHNICAL INTEGRITY OF THE SERVICES AND DESIGN NOR TRANSFER ANY PART OF THAT RESPONSIBILITY TO THE APPROVING OFFICIALS.

THE DESIGN CONSULTANT SHALL BE HELD RESPONSIBLE FOR THE FAILURE OF THE FACILITIES / STRUCTURES DUE TO FAULTY DESIGN EXCEPT FOR THE CHANGES MADE WITHOUT THE CONFORMITY OF THE CONSULTANTS.

DRAWINGS AND SPECIFICATIONS DULY SIGNED, STAMPED OR SEALED, AS INSTRUMENTS OF SERVICE, ARE PROPERTY AND DOCUMENTS OF THE ARCHITECT, WHETHER THE CLIENT FOR WHICH THEY ARE MADE IS EXECUTED OR NOT. IT SHALL BE UNLAWFUL FOR ANY PERSON, WITHOUT THE WRITTEN CONSENT OF THE ARCHITECT OR AUTHOR OF SAID DOCUMENTS, TO DUPLICATE OR TO MAKE COPIES OF SAID DOCUMENTS FOR USE IN THE REPEITION OF AND FOR OTHER PROJECTS OR BUILDINGS, WHETHER EXECUTED PARTIALLY OR IN WHOLE.

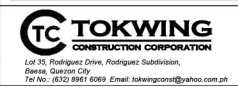

CONSULTANT: CESARI L. MADRUGA SANITARY ENGINEER	CHECKED: JOSE MANUEL AGUIBALDO PROJECT MANAGER	REVIEWED: ATTY. JOHNSON V. DOMINGO PROJECT DIRECTOR	RECOMMENDING APPROVAL: REYNOR P. IMPERIAL DIRECTOR II PLANNING AND MANAGEMENT SERVICE CO-HEAD, PSA-BOCM	APPROVED: SOCRATES L. RAMONER DIRECTOR IV ASSISTANT NATIONAL STATISTICIAN FINANCE AND ADMINISTRATIVE SERVICE HEAD, PSA-BOCM	APPROVED: LEO B. MALACAP ASSISTANT SECRETARY DEPUTY NATIONAL STATISTICIAN CIVIL REGISTRATION & CENTRAL SUPPORT OFFICE	APPROVED: USEC. CLAIRE DENNIS S. MAHA, PH.D. NATIONAL STATISTICIAN AND CIVIL REGISTRAR GENERAL PHILIPPINE STATISTICS AUTHORITY	PROJECT: CONSTRUCTION OF FIT-OUT AND LANDSCAPE WORKS FOR THE TWENTY-THREE (23) STOREY PHILIPPINE STATISTICS AUTHORITY (PSA) OFFICE BUILDING WITH COVERED ROOF DECK LOCATION: PSA COMPLEX, EAST AVENUE, DILIMAN, QUEZON CITY	SHEET CONTENT: GROUND FLOOR SANITARY LAYOUT	DESIGNER: E. OLONAN CAD: AET/ADI CHECKED: RIB/AET DATE: MAY 2021	REVISIONS: SYMBOL: REMARK: DATE:	SHEET NO.: S-02
---	--	---	---	--	---	---	---	--	---	---	--------------------