

LEGEND:

FLOOR FINISH LEGEND :

FLOOR FINISHES	
F-1	POLYURETHANE-BASED EPOXY FLOOR COATING
F-2	BARE STRUCTURAL CONCRETE SLAB DEPRESSED 50MM TO RECEIVE TOPPING AND FINISH
F-3	600mm x 600mm x 8mm THK NON-SKID FLOOR TILE
F-4	600mm x 600mm x 8mm THK POLISHED FLOOR TILE
F-5	EPOXY TANK LINING
F-6	CEMENT-BASED NON-SKID WAFFLE TILE
F-7	WET-INSTALLED 20mm THK FLAMED GRANITE SLAB (PROVIDE SEALER)
F-8	TROWEL FINISH WITH PENETRATING SEALER AND HARDENER
F-9	600mm x 600mm CARPET TILES
F-10	RUBBERIZED MAT FLOORING
F-11	SIMULATED WOOD TILES
F-12	600mm x 600mm x 10mm THK POLISHED GRANITE FLOOR TILE

PARTITION TYPE LEGEND :

FLOOR FINISHES	
P-1	125mm THK. CAST-IN-PLACE CONCRETE EXTERIOR WALL
P-2	REINFORCED STRUCTURAL CONCRETE WALL
P-3	150mm THK. CHB 2HR FIRE RATED (FLOOR TO BOTTOM SLAB/BEAM) PLASTERED AND FINISH AS PER WALL FINISHED SCHEDULE
P-4	150mm THK. CHB (FLOOR TO BOTTOM SLAB/BEAM) PLASTERED AND FINISH AS PER WALL FINISHED SCHEDULE
P-5a	100mm THK. FULL HT DRY WALL PARTITION w/ 9HR FIRE RATING, GYPSUM BOARD ON METAL FURRINGS PLASTERED AND FINISHED AS PER WALL FINISH SCHED.
P-5b	100mm THK. 1.8m HT DRY WALL PARTITION w/ 2HR FIRE RATING, GYPSUM BOARD ON METAL FURRINGS PLASTERED AND FINISHED AS PER WALL FINISH SCHED.
P-6	12mm THK CLEAR SEMI-FRAMELESS FULL HT TEMPERED GLASS WALL PARTITION w/ MID-HT FROSTED STICKER BAND

WALL FINISH LEGEND :

FLOOR FINISHES	
W-1	SEMI-GLOSS LATEX PAINT FINISH
W-2	500X600X25mm THK. POLISHED HOMOGENOUS WALL TILE
W-3	600X600X25mm THK. POLISHED HOMOGENOUS GRANITE WALL TILE
W-4	EPOXY LINING
W-5	LIQUID-APPLIED ELASTOMERIC WALL COATING
W-6	LIQUID-APPLIED ELASTOMERIC WALL COATING + DRY-INSTALLED GRANITE SLAB ON STAINLESS STEEL ANCHORS
W-7	PAINTED FINISH WITH TRAFFIC STRIPE PATTERN
W-8	DECORATIVE WALL STICKER ON SKIM COAT WALL COATING
W-9	ACOUSTIC PADDING

CEILING FINISHES LEGEND :

CEILING FINISHES	
C-1	LOW SHEEN ACRYLIC LATEX PAINT ON SMOOTH RUBBED FINISHED EXPOSED UNDERSIDE OF SLAB/ BEAM
C-2	LOW SHEEN ACRYLIC LATEX PAINT ON 12mm THK MOISTURE RESISTANT GYPSUM BOARD ON METAL CEILING JOIST
C-3	600X600 REGULAR ACOUSTIC TILES ON POWDER COATED ALUMINUM T RUNNERS
C-4	POWDER COATED ALUMINUM PANELS ON CONCEALED ALUMINUM RUNNERS
C-5	12mm THK. GYPSUM BOARD IN HPL METAL FIN. AND 6mm THK. GRAPHICOTE GLASS PANELS ON POWDER COATED ALUMINUM FRAMING WITH 6mm THK. ACRYLIC DIFFUSERS
C-6	LOW SHEEN ACRYLIC LATEX PAINT ON 12mm THK GYPSUM BOARD ON METAL CEILING JOIST
C-7	ALUMINUM COMPOSITE CEILING PANEL
C-8	LOW SHEEN ACRYLIC LATEX PAINT ON 12mm THK GYPSUM BOARD HEXAGONAL ACCENT DROP CEILING 120H DIA X 150mm THK ON METAL HANGERS.

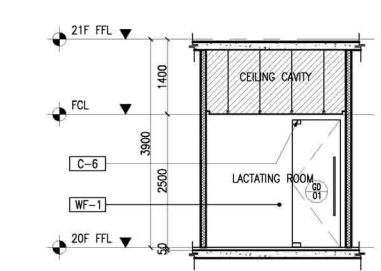
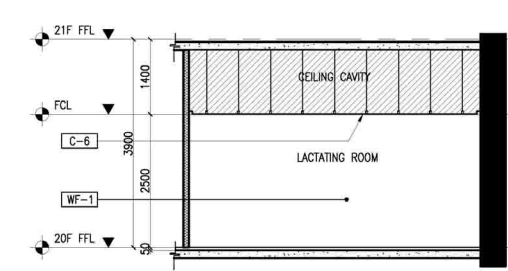
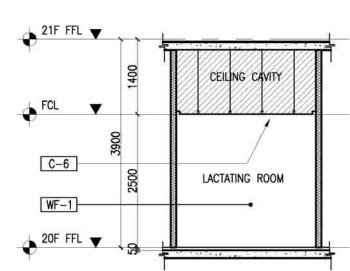
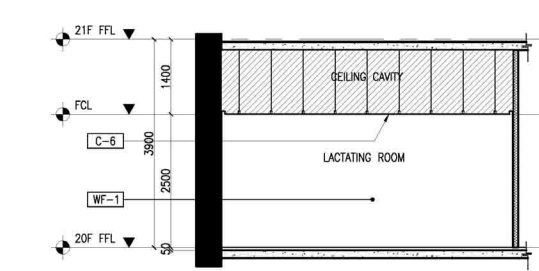
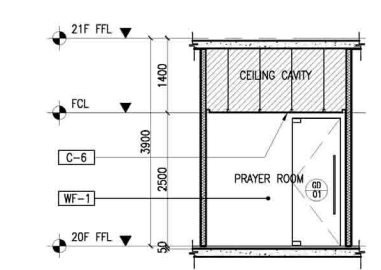
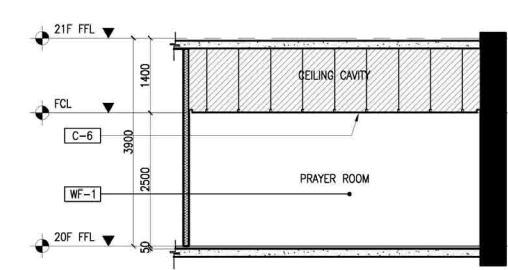
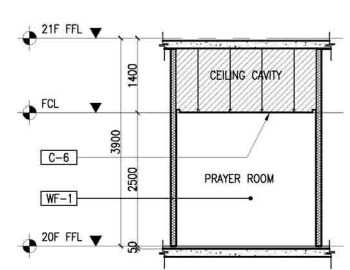
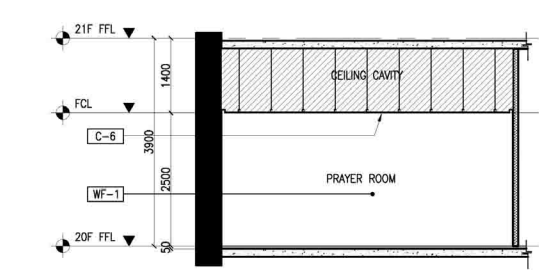
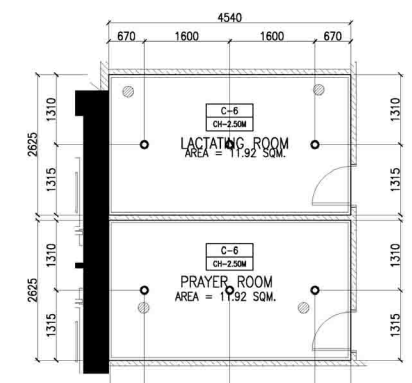
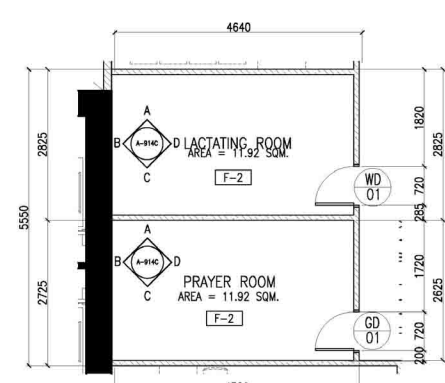
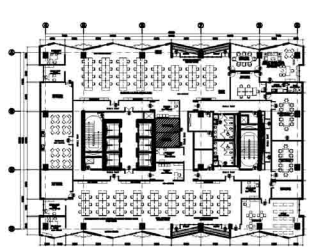
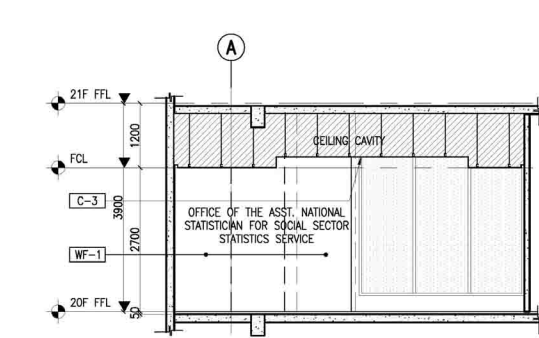
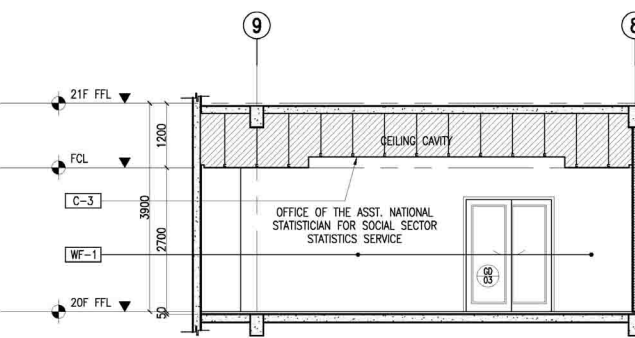
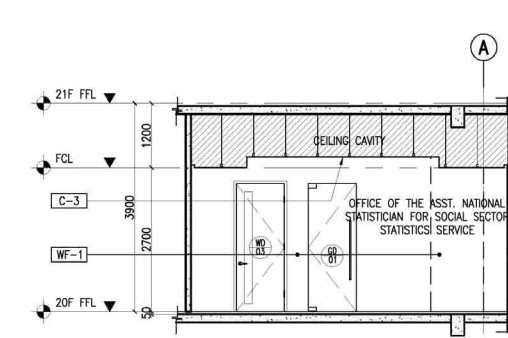
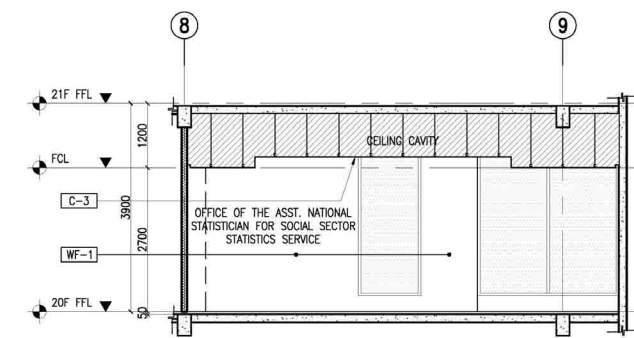

NOTE:
 PURSUANT TO SECTION 4 OF ANNEX "A" OF THE REVISED IMPLEMENTING RULES AND REGULATION OF R.A. 9164, APPROVAL BY THE AUTHORIZED DPWH OFFICIALS OF DETAILED ENGINEERING SURVEYS AND DESIGN UNDERTAKEN BY CONSULTANTS NEITHER DIMINISHES THE RESPONSIBILITY OF THE LATTER FOR THE TECHNICAL INTEGRITY OF THE SURVEYS AND DESIGN NOR TRANSFER ANY PART OF THAT RESPONSIBILITY TO THE APPROVING OFFICIALS.
 THE DESIGN CONSULTANT SHALL BE HELD RESPONSIBLE FOR THE FAILURE OF THE FACILITY/IES / STRUCTURES DUE TO FAULTY DESIGN EXCEPT FOR THE CHANGES MADE WITHOUT THE CONFORMITY OF THE CONSULTANTS.

DRAWINGS AND SPECIFICATIONS DULY SIGNED, STAMPED OR SEALED, AS INSTRUMENTS OF SERVICE ARE PROPERTY AND DOCUMENTS OF THE ARCHITECT, WHETHER THE OBJECT FOR WHICH THEY ARE MADE IS EXECUTED OR NOT. IT SHALL BE UNLAWFUL FOR ANY PERSON, WITHOUT THE WRITTEN CONSENT OF THE ARCHITECT OR AUTHOR OF SAID DOCUMENTS, TO DUPLICATE OR TO MAKE COPIES OF SAID DOCUMENTS FOR USE IN THE REPEITION OF AND FOR OTHER PROJECTS OR BUILDINGS, WHETHER EXECUTED PARTLY OR IN WHOLE.

<p>TOKWING CONSTRUCTION CORPORATION Suite 203, 36th Street, Quezon City Manila, Quezon City Tel No. (632) 891 8959 Email: tokwingcorp@yahoo.com</p>	<p>ENRIQUE O. OLANAN & ASSOCIATES ARCHITECTS ENGINEERS CONSULTANTS Suite 203, 36th Street, Quezon City Manila, Quezon City Tel No. (632) 7917 5338 Email: enobasedesign@gmail.com</p>	CONSULTANT: ENRIQUE O. OLANAN ARCHITECT REG. NO. 4643 DATE: 04/29/2023	CHECKED: JOSE MANUEL AGUILARDO PROJECT MANAGER & BUILDING & SPECIAL PROJECTS MANAGEMENT CLUSTER UNIFIED PROJECT MANAGEMENT OFFICE, DPWH	REVIEWED: ATTY. JOHNSON V. DOMINCO DIRECTOR PLANNING AND MANAGEMENT SERVICE CO-HEAD, PSA-BOCM	RECOMMENDING APPROVAL: REYNOR B. IMPERIAL DIRECTOR PLANNING AND MANAGEMENT SERVICE CO-HEAD, PSA-BOCM	APPROVED: LEO B. MALAGAR ASSISTANT SECRETARY DEPUTY NATIONAL STATISTICIAN CIVIL REGISTRATION & GENERAL SUPPORT OFFICE PSA-BOCM	PROJECT: CONSTRUCTION OF FIT-OUT AND LANDSCAPE WORKS FOR THE TWENTY-THREE (23) STOREY PHILIPPINE STATISTICS AUTHORITY (PSA) OFFICE BUILDING WITH COVERED ROOF DECK LOCATION: PSA COMPLEX, EAST AVENUE, DILIMAN, QUEZON CITY	SHEET CONTENT: 20TH FLOOR BLOW-UP DETAILS	DESIGNER: E. OLANAN CAD: AET / ADI CHECKED: RIB / AET DATE: MAY 2021	REVISIONS: SYMBO, REMARK, DATE	SHEET NO.: A-914C
		PROJECT: CONSTRUCTION OF FIT-OUT AND LANDSCAPE WORKS FOR THE TWENTY-THREE (23) STOREY PHILIPPINE STATISTICS AUTHORITY (PSA) OFFICE BUILDING WITH COVERED ROOF DECK LOCATION: PSA COMPLEX, EAST AVENUE, DILIMAN, QUEZON CITY									