

FLOOR FINISH LEGEND :	
NEW FINISHES	
F-1	BARE STRUCTURAL CONCRETE SLAB, DEPRESSED 50mm TO RECEIVE TOPPING AND FINISH
F-2	600mm x 600mm CARPET TILES
F-3	600mm x 600mm x 8mm THK NON-SKID FLOOR TILE
F-4	600mm x 600mm x 8mm THK POLISHED FLOOR TILE
F-5	RUBBERIZED MAT FLOORING
F-6	SIMULATED WOOD TILES
F-7	600mm x 600mm x 10mm THK POLISHED GRANITE FLOOR TILE
EXISTING FINISHES	
EX-01	POLYURETHANE-BASED EPOXY FLOOR COATING
EX-02	EPOXY TANK LINING
EX-03	CEMENT-BASED NON-SKID WAFFLE TILE
EX-04	WET-INSTALLED 20mm THK FLAMED GRANITE SLAB (PROVIDE SEALER)
EX-05	TROWEL FINISH WITH PENETRATING SEALER AND HARDENER
EX-06	600mm x 600mm x 8mm THK NON-SKID FLOOR TILE
EX-07	600mm x 600mm x 10mm THK POLISHED GRANITE FLOOR TILE
EX-08	600mm x 600mm x 8mm THK POLISHED FLOOR TILE
CEILING FINISHES LEGEND :	
NEW FINISHES	
C-1	LOW SHEEN ACRYLIC LATEX PAINT ON SMOOTH RUBBED FINISHED EXPOSED UNDERSIDE OF SLAB/ BEAM
C-2	LOW SHEEN ACRYLIC LATEX PAINT ON 12mm THK MOISTURE RESISTANT GYPSUM BOARD ON METAL CEILING JOIST
C-3	600X600 REGULAR ACOUSTIC TILES ON POWDER COATED ALUMINUM T RUNNERS
C-4	POWDER COATED ALUMINUM PANELS ON CONCEALED ALUMINUM RUNNERS
C-5	12mm THK GYPSUM BOARD IN HPL METAL FIN. AND 6mm THK GRAPHICOTE GLASS PANELS ON POWDER COATED ALUMINUM FRAMING WITH 6mm THK ACRYLIC DIFFUSERS
C-6	LOW SHEEN ACRYLIC LATEX PAINT ON 12mm THK GYPSUM BOARD ON METAL CEILING JOIST
C-7	ALUMINUM COMPOSITE CEILING PANEL
C-8	LOW SHEEN ACRYLIC LATEX PAINT ON 12mm THK GYPSUM BOARD HEXAGONAL ACCENT DROP CEILING 1200 DIA x 150mm THK ON METAL HANGERS
EXISTING FINISHES	
EXC-1	LOW SHEEN ACRYLIC LATEX PAINT ON SMOOTH RUBBED FINISHED EXPOSED UNDERSIDE OF SLAB/ BEAM
EXC-2	LOW SHEEN ACRYLIC LATEX PAINT ON 12mm THK MOISTURE RESISTANT GYPSUM BOARD ON METAL CEILING JOIST
EXC-3	LOW SHEEN ACRYLIC LATEX PAINT ON 12mm THK GYPSUM BOARD ON METAL CEILING JOIST
WALL FINISH LEGEND :	
EXISTING FINISHES	
EXW-1	SEMI-GLOSS LATEX PAINT FINISH
EXW-2	300X600X25mm THK POLISHED HOMOGENOUS WALL TILE
EXW-3	EPOXY LINING
EXW-4	LIQUID-APPLIED ELASTOMERIC WALL COATING
EXW-5	PAINTED FINISH WITH TRAFFIC STRIPE PATTERN
NEW FINISHES	
WF-1	SEMI-GLOSS LATEX PAINT FINISH
WF-2	300X600X25mm THK POLISHED HOMOGENOUS WALL TILE
WF-3	SKIM COAT WALL COATING FINISH
WF-4	ACOUSTIC PADDING
WF-5	4mm THK. COLOR COATED GLASS
WF-6	WOOD VENEER (VERIFY DESIGN ON DETAILS)
PARTITION TYPE LEGEND :	
EXISTING PARTITION	
EXP-1	125mm THK. CAST-IN-PLACE CONCRETE EXTERIOR WALL
EXP-2	REINFORCED STRUCTURAL CONCRETE WALL
EXP-3	150mm THK. CHB (FLOOR TO BOTTOM SLAB/BEAM) PLASTERED AND FINISH AS PER WALL FINISHED SCHEDULE
EXP-4	150mm THK. CHB (FLOOR TO BOTTOM SLAB/BEAM) PLASTERED AND FINISH AS PER WALL FINISHED SCHEDULE
NEW PARTITION	
P-1	150mm THK. CHB (FLOOR TO BOTTOM SLAB/BEAM) PLASTERED AND FINISH AS PER WALL FINISHED SCHEDULE
P-2	100mm THK. FULL HT DRY WALL PARTITION w/ 2HR FIRE RATING, GYPSUM BOARD ON METAL FURRING PLASTERED AND FINISHED AS PER WALL FINISH SCHED.
P-3	100mm THK. 1.8m HT DRY WALL PARTITION w/ 2HR FIRE RATING, GYPSUM BOARD ON METAL FURRING PLASTERED AND FINISHED AS PER WALL FINISH SCHED.
P-4	100mm THK. DRY WALL CLADDING IN 200MM ABOVE FINISH FLOOR LINE (SEE INTERIOR DETAILS)
P-5	12mm THK CLEAR SEMI-FRAMELESS FULL HT TYPHRED GLASS WALL PARTITION w/ MID-HT FROSTED STICKER BAND

NOTE:
PURSUANT TO SECTION 4 OF ANNEX "A" OF THE REVISED IMPLEMENTING RULES AND REGULATION OF R.A. 9164, APPROVAL BY THE AUTHORIZED DPWH OFFICIALS OF DETAILED ENGINEERING SURVEYS AND DESIGN UNDERTAKEN BY CONSULTANTS NEITHER DIMINISHES THE RESPONSIBILITY OF THE LATTER FOR THE TECHNICAL INTEGRITY OF THE SURVEYS AND DESIGN NOR TRANSFER ANY PART OF THAT RESPONSIBILITY TO THE APPROVING OFFICIALS.

THE DESIGN CONSULTANT SHALL BE HELD RESPONSIBLE FOR THE FAILURE OF THE FACILITY/IES / STRUCTURES DUE TO FAULTY DESIGN EXCEPT FOR THE CHANGES MADE WITHOUT THE CONFORMITY OF THE CONSULTANTS.

DRAWINGS AND SPECIFICATIONS DULY SIGNED, STAMPED OR SEALED, AS INSTRUMENTS OF SERVICE, ARE PROPERTY AND DOCUMENTS OF THE ARCHITECT, WHETHER THE OBJECT FOR WHICH THEY ARE MADE IS EXECUTED OR NOT. IT SHALL BE UNLAWFUL FOR ANY PERSON, WITHOUT THE WRITTEN CONSENT OF THE ARCHITECT OR AUTHOR OF SAID DOCUMENTS, TO DUPLICATE OR TO MAKE COPIES OF SAID DOCUMENTS FOR USE IN THE REPETITION OF AND FOR OTHER PROJECTS OR BUILDINGS, WHETHER EXECUTED PARTLY OR IN WHOLE.



1 SISS STAFF RECEIVING AREA
11TH FLOOR KEYPLAN
A-906G SCALE: 1:500M.

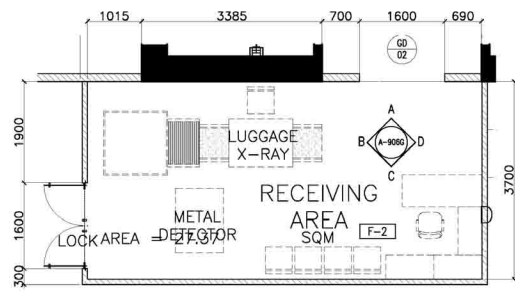

2 11F - SISS STAFF RECEIVING AREA
BLOW-UP PLAN
A-906G SCALE: 1:50M.

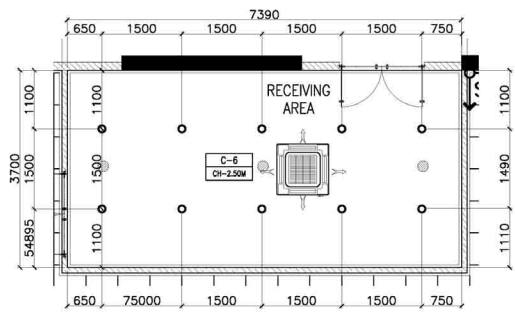

3 11F - SISS STAFF RECEIVING AREA
REFLECTED CEILING PLAN
A-906G SCALE: 1:50M.

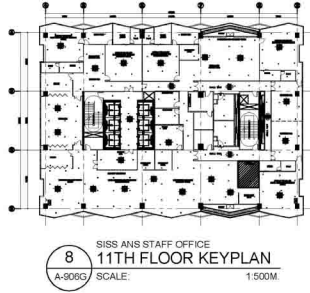

8 SISS ANS STAFF OFFICE
11TH FLOOR KEYPLAN
A-906G SCALE: 1:500M.

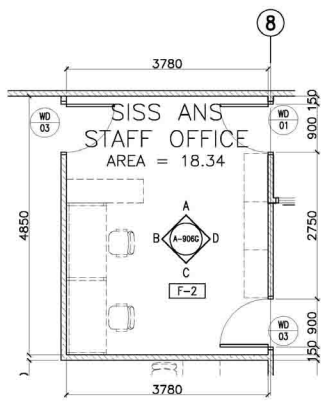

9 11F - SISS ANS STAFF OFFICE
BLOW-UP PLAN
A-906G SCALE: 1:50M.

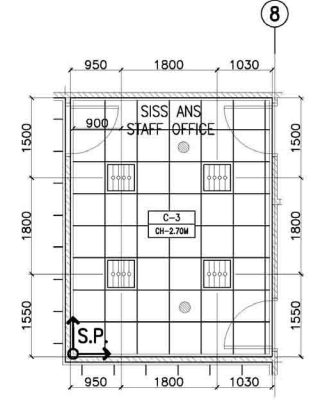

10 11F - SISS ANS STAFF OFFICE
REFLECTED CEILING PLAN
A-906G SCALE: 1:50M.

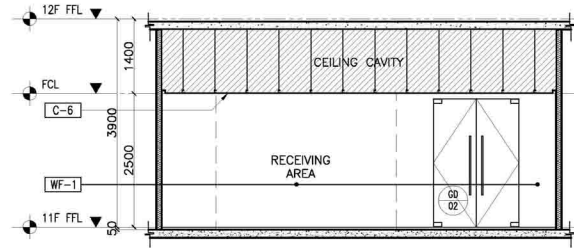

4 11F - SISS STAFF RECEIVING AREA
SECTION THRU "A"
A-906G SCALE: 1:50M.

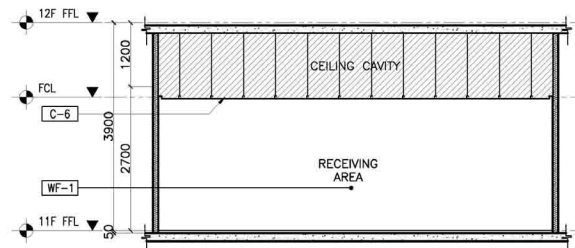

6 11F - SISS STAFF RECEIVING AREA
SECTION THRU "C"
A-906G SCALE: 1:50M.

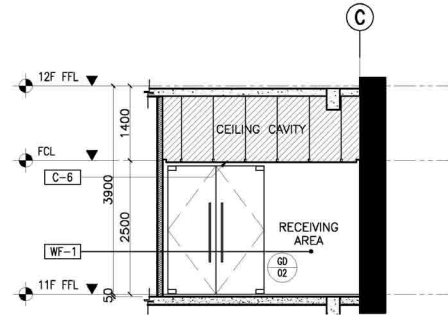

5 11F - SISS STAFF RECEIVING AREA
SECTION THRU "B"
A-906G SCALE: 1:50M.

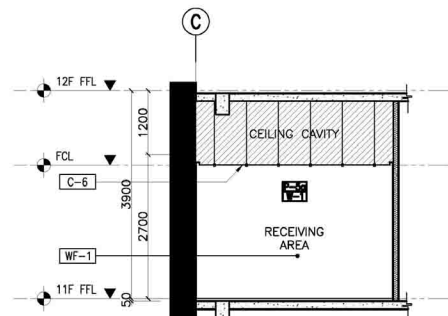

7 11F - SISS STAFF RECEIVING AREA
SECTION THRU "D"
A-906G SCALE: 1:50M.

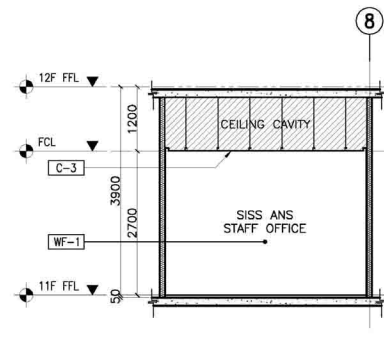

11 11F - SISS ANS STAFF OFFICE
SECTION THRU "A"
A-906G SCALE: 1:50M.

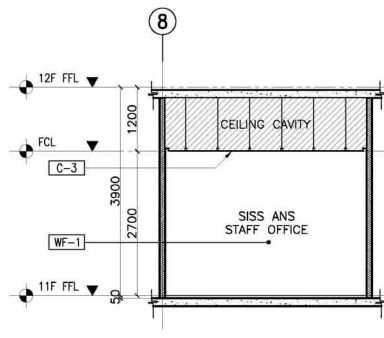

13 11F - SISS ANS STAFF OFFICE
SECTION THRU "C"
A-906G SCALE: 1:50M.

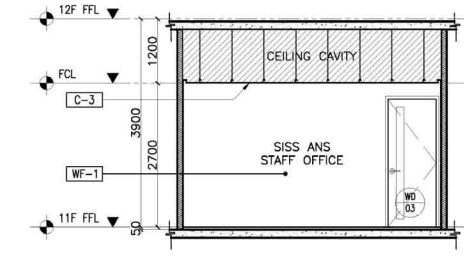

12 11F - SISS ANS STAFF OFFICE
SECTION THRU "B"
A-906G SCALE: 1:50M.

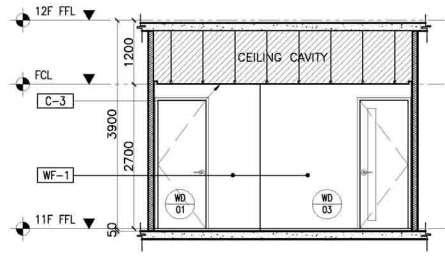

14 11F - SISS ANS STAFF OFFICE
SECTION THRU "D"
A-906G SCALE: 1:50M.

TOKWING CONSTRUCTION CORPORATION Luis 33, Rodriguez Drive, Rodriguez, Subdivisions, Marikina City, Philippines Tel No. (832) 891 8959 Email: tokwingcorp@yahoo.com.ph		ENRIQUE O. OLANAN & ASSOCIATES ARCHITECTS ENGINEERS CONSULTANTS Suite 303, Juvareville Square Condominiums, Juvareville Avenue, Juvareville, Marikina City Tel No. (832) 7917 5358 Email: enobrandesign@gmail.com		CONSULTANT: ENRIQUE O. OLANAN ARCHITECT REG. NO. 4643 P.E. NO. 2508861 DATE: 04/29/2023 SHEET: 100-149-814 QUEZON CITY	CHECKED: JOSE MANUEL AGUILARDO PROJECT MANAGER BUILDING & SPECIAL PROJECTS MANAGEMENT CLUSTER UNIFIED PROJECT MANAGEMENT OFFICE, DPWH	REVIEWED: ATTY. JOHNSON V. DOMINGO DIRECTOR IV PLANNING AND MANAGEMENT SERVICE UNIFIED PROJECT MANAGEMENT OFFICE, DPWH	RECOMMENDING APPROVAL: REYNOR B. IMPERIAL DIRECTOR III PLANNING AND MANAGEMENT SERVICE CO-HEAD, PSA-BOCM	APPROVED: SOCRATES L. RAMORIS DIRECTOR IV FINANCE AND ADMINISTRATIVE SERVICE HEAD, PSA-BOCM	APPROVED: LEO B. MALAGAR DIRECTOR IV ASSISTANT SECRETARY DEPUTY NATIONAL STATISTICIAN CIVIL REGISTRATION & GENERAL SUPPORT OFFICE	APPROVED: USEG, CLAIRE DENNIS S. MAPA, PH. D. NATIONAL STATISTICIAN AND CIVIL REGISTRAR GENERAL PHILIPPINE STATISTICS AUTHORITY	PROJECT: CONSTRUCTION OF FIT-OUT AND LANDSCAPE WORKS FOR THE TWENTY-THREE (23) STOREY PHILIPPINE STATISTICS AUTHORITY (PSA) OFFICE BUILDING WITH COVERED ROOF DECK LOCATION: PSA COMPLEX, EAST AVENUE, DILIMAN, QUEZON CITY	SHEET CONTENT: IITH FLOOR DETAILS	DESIGNER: E. OLANAN CAD AET / ADI CHECKED RIB / AET DATE MAY 2021	REVISIONS: SYMBOL REMARK DATE	SHEET NO.: A-906G
--	--	--	--	---	---	--	--	---	--	--	---	--------------------------------------	--	--	----------------------

FLOOR FINISH LEGEND :

NEW FINISHES

F-1

BARE STRUCTURAL CONCRETE SLAB
DEPRESSED 50mm TO RECEIVE TOPPING AND
FINISH

F-2

600mm x 600mm CARPET TILES

F-3

600mm x 600mm x 8mm THK NON-SKID FLOOR
TILE

F-4

600mm x 600mm x 8mm THK POLISHED FLOOR
TILE

F-5

RUBBERIZED MAT FLOORING

F-6

SIMULATED WOOD TILES

F-7

600mm x 600mm x 10mm THK POLISHED
GRANITE FLOOR TILE

EXISTING FINISHES

EX-01

POLYURETHANE-BASED EPOXY FLOOR
COATING

EX-02

EPOXY TANK LINING

EX-03

CEMENT-BASED NON-SKID WAFFLE TILE

EX-04

WET-INSTALLED 20mm THK FLAMED GRANITE
SLAB (PROVIDE SEALER)

EX-05

TROWEL FINISH WITH PENETRATING SEALER
AND HARDENER

EX-06

600mm x 600mm x 8mm THK NON-SKID FLOOR
TILE

EX-07

600mm x 600mm x 10mm THK POLISHED
GRANITE FLOOR TILE

EX-08

600mm x 600mm x 8mm THK POLISHED FLOOR
TILE

CEILING FINISHES LEGEND :

NEW FINISHES

C-1

LOW SHEEN ACRYLIC LATEX PAINT ON
SMOOTH RUBBED FINISHED EXPOSED
UNDERSIDE OF SLAB/ BEAM

C-2

LOW SHEEN ACRYLIC LATEX PAINT ON 12mm
THK MOISTURE RESISTANT GYPSUM BOARD ON
METAL CEILING JOIST

C-3

600x600 REGULAR ACOUSTIC TILES ON
POWDER COATED ALUMINUM T RUNNERS

C-4

POWDER COATED ALUMINUM PANELS ON
CONCEALED ALUMINUM RUNNERS

C-5

12mm THK GYPSUM BOARD ON HPL METAL FIN.
AND 6mm THK GRAPHICOTE GLASS PANELS
ON POWDER COATED ALUMINUM FRAMING
WITH 6mm THK ACRYLIC DIFFUSERS

C-6

LOW SHEEN ACRYLIC LATEX PAINT ON 12mm THK
GYPSUM BOARD ON METAL CEILING JOIST

C-7

ALUMINUM COMPOSITE CEILING PANEL

C-8

LOW SHEEN ACRYLIC LATEX PAINT ON 12mm THK
GYPSUM BOARD HEXAGONAL ACCENT DROP
CEILING 1200 DIA x 150mm THK ON METAL
HANGERS

EXISTING FINISHES

EXC-1

LOW SHEEN ACRYLIC LATEX PAINT ON SMOOTH
RUBBED FINISHED EXPOSED UNDERSIDE OF
SLAB/ BEAM

EXC-2

LOW SHEEN ACRYLIC LATEX PAINT ON 12mm
THK MOISTURE RESISTANT GYPSUM BOARD ON
METAL CEILING JOIST

EXC-3

LOW SHEEN ACRYLIC LATEX PAINT ON 12mm THK
GYPSUM BOARD ON METAL CEILING JOIST

WALL FINISH LEGEND :

EXISTING FINISHES

EXW-1

SEMI-GLOSS LATEX PAINT FINISH

EXW-2

300x600x25mm THK POLISHED HOMOGENOUS WALL
TILE

EXW-3

EPOXY LINING

EXW-4

LIQUID-APPLIED ELASTOMERIC WALL COATING

EXW-5

PAINTED FINISH WITH TRAFFIC STRIPE PATTERN

NEW FINISHES

WF-1

SEMI-GLOSS LATEX PAINT FINISH

WF-2

300x600x25mm THK POLISHED HOMOGENOUS
WALL TILE

WF-3

SKIM COAT WALL COATING FINISH

WF-4

ACOUSTIC PADDING

WF-5

6mm THK COLOR COATED GLASS

WF-6

WOOD VENEER (VERIFY DESIGN ON DETAILS)

PARTITION TYPE LEGEND :

EXISTING PARTITION

EXP-1

125mm THK CAST-IN-PLACE CONCRETE
EXTERIOR WALL

EXP-2

REINFORCED STRUCTURAL CONCRETE WALL

EXP-3

150mm THK CHB 2HR FIRE RATED (FLOOR TO
BOTTOM SLAB/BEAM) PLASTERED AND FINISH AS
PER WALL FINISHED SCHEDULE

EXP-4

150mm THK CHB (FLOOR TO BOTTOM SLAB/BEAM)
PLASTERED AND FINISH AS PER WALL FINISHED
SCHEDULE

NEW PARTITION

P-1

150mm THK CHB (FLOOR TO BOTTOM SLAB/BEAM)
PLASTERED AND FINISH AS PER WALL FINISHED
SCHEDULE

P-2

100mm THK FULL HT DRY WALL PARTITION w/ 2HR
FIRE RATING GYPSUM BOARD ON METAL
FURRING PLASTERED AND FINISHED AS PER
WALL FINISH SCHED.

P-3

100mm THK 1.8m HT DRY WALL PARTITION w/ 2HR
FIRE RATING GYPSUM BOARD ON METAL
FURRING PLASTERED AND FINISHED AS PER
WALL FINISH SCHED.

P-4

100mm THK DRY WALL CLADDING IN 200MM ABOVE
FINISH FLOOR LINE (SEE INTERIOR DETAILS)

P-5

12mm THK CLEAR SEMI-FRAMELESS FULL HT
TEMPERED GLASS WALL PARTITION w/ MID-HT
FROSTED STICKER BAND

NOTE:

PURSUANT TO SECTION 4 OF ANNEX "A" OF THE
REVISED IMPLEMENTING RULES AND REGULATION OF
R.A. 9164, APPROVAL BY THE AUTHORIZED DPWH
OFFICIALS OF DETAILED ENGINEERING SURVEYS AND
DESIGN UNDERTAKEN BY CONSULTANTS NEITHER
DIMINISHES THE RESPONSIBILITY OF THE LATTER FOR
THE TECHNICAL INTEGRITY OF THE SURVEYS AND
DESIGN NOR TRANSFER ANY PART OF THAT
RESPONSIBILITY TO THE APPROVING OFFICIALS.

THE DESIGN CONSULTANT SHALL BE HELD
RESPONSIBLE FOR THE FAILURE OF THE FACILITY/IES
/ STRUCTURES DUE TO FAULTY DESIGN EXCEPT FOR
THE CHANGES MADE WITHOUT THE CONFORMITY OF
THE CONSULTANTS.

DRAWINGS AND SPECIFICATIONS DULY SIGNED, STAMPED
OR SEALED, AS INSTRUMENTS OF SERVICE, ARE
PROPERTY AND DOCUMENTS OF THE ARCHITECT.
WHETHER THE OBJECT FOR WHICH THEY ARE MADE IS
EXECUTED OR NOT, IT SHALL BE UNLAWFUL FOR ANY
PERSON, WITHOUT THE WRITTEN CONSENT OF THE
ARCHITECT OR AUTHOR OF SAID DOCUMENTS, TO
DUPLICATE OR TO MAKE COPIES OF SAID DOCUMENTS
FOR USE IN THE REPRODUCTION OF AND FOR OTHER
PROJECTS OR BUILDINGS, WHETHER EXECUTED PARTLY
OR IN WHOLE.

TOKWING

CONSTRUCTION CORPORATION

ENRIQUE O. OLANAN

ARCHITECT

ENRIQUE O. OLANAN

ARCHITECTS ENGINEERS CONSULTANTS

4643

04/09/2023

02/20/2022

100-149-814

CONSULTANT:

CHECKED:

REVIEWED:

RECOMMENDING APPROVAL:

APPROVED:

PROJECT:

JOSE MANUEL AGUILARDO

PROJECT MANAGER & DIRECTOR

BUILDING & SPECIAL PROJECTS MANAGEMENT CLUSTER

UNITED PROJECT MANAGEMENT OFFICE, DPWH

ATTY. JOHNSON V. DOMINGO

PROJECT DIRECTOR

BUILDING & SPECIAL PROJECTS MANAGEMENT CLUSTER

UNITED PROJECT MANAGEMENT OFFICE, DPWH

REYNOR B. IMPERIAL

PLANNING AND MANAGEMENT SERVICE

CO-HEAD, PSA-BOCM

SOCRATES L. RAMORES

FINANCE AND ADMINISTRATIVE SERVICE

HEAD, PSA-BOCM

LEO B. MALAGAR

ASSISTANT SECRETARY

DEPUTY NATIONAL STATISTICIAN

CIVIL REGISTRATION & GENERAL SUPPORT OFFICE

USBC, CLAIRE DENNIS S. MAPA, PH. D.

NATIONAL STATISTICIAN AND CIVIL REGISTRAR GENERAL

PHILIPPINE STATISTICS AUTHORITY

CONSTRUCTION OF FIT-OUT AND LANDSCAPE WORKS FOR THE
TWENTY-THREE (23) STOREY PHILIPPINE STATISTICS AUTHORITY (PSA)
OFFICE BUILDING WITH COVERED ROOF DECK

LOCATION: PSA COMPLEX, EAST AVENUE, DILIMAN, QUEZON CITY

SHEET CONTENT

DESIGNER

EAD

CHECKED

DATE

E. OLANAN

AET / ADI

RIB / AET

MAY 2021

REVISIONS

SYMBOL

REMARK

DATE

SHEET NO.

A-906H