

COMMON FURNITURE FINISHES	LEGEND:																	
	WS	8 SET/S	700MM X 1400MM WORKSTATION IN HPL FINISH WITH 6500 SYSTEM PARTITION 1200MM HT.	LF3	3 SET/S	CENTER TABLE IN HPL FINISH 600MM X 1000MM X 500MM HT. TOP IN HPL FINISH	CB2	4 SET/S	450MM X 1350MM X 750MM HT. SWING DOOR CABINET WITH DRAWER IN HPL FINISH	GT1	1 SET/S	CENTER TABLE WITH GLASS TOP 900MM X 900MM X 500MM HT.	C1	36 SET/S	THETA 2-2 MID BACK CHAIR	R1	5 SET/S	RABAMI
	MT2	3 SET/S	1500MM X 4500MM MEETING TABLE WITH BOX LEGS 50MM THK. TOP IN HPL FINISH	PT3	4 SET/S	SQUARE PANTRY TABLE IN HPL FINISH 950MM X 950MM X 750MM HT. WITH METAL X-LEGS	HC	2 SET/S	600MM X 900MM X 2100MM HT. OPEN SHELVES CABINET IN HPL FINISH				C2	36 SET/S	BETA 2 CHAIR WITH ADJUSTABLE ARMS	R6	16 SET/S	DELTA UPHOLSTERED SEAT AND BACK
	MT4	1 SET/S	1200MM X 3000MM MEETING TABLE WITH BOX LEGS 50MM THK. TOP IN HPL FINISH	RC2	1 SET/S	CURVED RECEPTION COUNTER 2000MM X 4000MM X 1050MM HT. IN HPL FINISH	RT3	5 SET/S	ROUND TABLE IN HPL FINISH 500MM DIA. X 500MM HT. WITH METAL LEGS				C4	3 SET/S	C-SHAPE MODULAR SOFA	S3	1 SET/S	LE CORBUSIER CLUB CHAIR 2 - SEATER
	MT6	2 SET/S	1200MM X 2000MM MEETING TABLE WITH BOX LEGS 50MM THK. TOP IN HPL FINISH	ET2	5 SET/S	800MM X 1800MM /SIDE CABINET 450MM X 1800MM X 750MM HT. EXEC. DESK IN HPL FINISH	D12	1 SET/S	SQUARE DINING TABLE 600MM X 600MM X 750MM HT. IN HPL FINISH				C7	34 SET/S	ALUMINUM SLIM CHAIR	S4	10 SET/S	LE CORBUSIER CLUB CHAIR 1 - SEATER
	MT7	1 SET/S	1200MM X 2500MM MEETING TABLE WITH BOX LEGS 50MM THK. TOP IN HPL FINISH	BC	5 SET/S	450MM X 1800MM X 2100MM HT. BACK CABINET IN HPL FINISH	ST2	11 SET/S	SIDE TABLE IN HPL FINISH 550MM X 550MM X 500MM HT. WITH METAL LEGS				C8	5 SET/S	ERGONOMY MESH HIGHBACK	S5	6 SET/S	LE CORBUSIER CLUB CHAIR 3 - SEATER
	LF1	15 SET/S	4 LAYER LATERAL FILING CABINET IN POWDER COATED FINISH	CB1	6 SET/S	450MM X 1800MM X 750MM HT. SWING DOOR CABINET WITH DRAWER IN HPL FINISH	GT	6 SET/S	CENTER TABLE WITH GLASS TOP 450MM X 700MM X 500MM HT.				C9	20 SET/S	THETA EXEC. CANTILEVER			

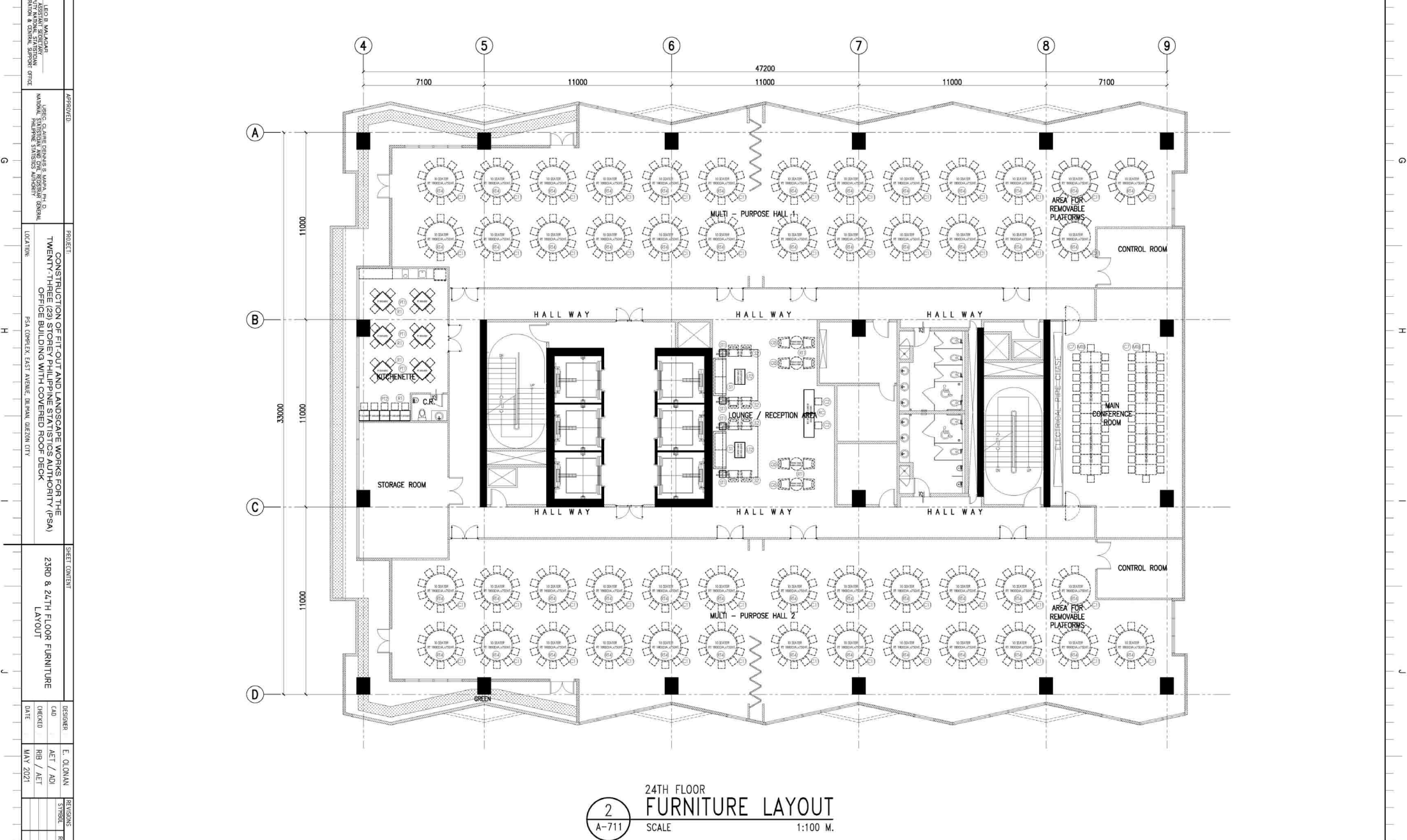

REF.	DATE	LEGEND:									
		RC		MT8		C2		S2			
A-711		1 SET/S	RECEPTION COUNTER 600MM X 2800MM X 1050MM HT. IN HPL FINISH	4 SET/S	1200MM X 3600MM MEETING TABLE WITH 40x40 METAL LEGS AND WIRE MANAGEMENT IN HPL FINISH	2 SET/S	BETA 2 CHAIR WITH ADJUSTABLE ARMS	8 SET/S	KAYU SOFA 1 - SEATER		
		2 SET/S	CENTER TABLE IN HPL FINISH 600MM X 900MM X 500MM HT. WITH METAL LEGS	50 SET/S	1800MM DIA. X 750MM HT. ROUND TABLE WITH METAL LEGS IN HPL FINISH	52 SET/S	EDEN CHAIR				
		4 SET/S	ROUND TABLE IN HPL FINISH 750MM DIA. X 750MM HT. WITH METAL LEGS			C11	494 SET/S	LEAF CHAIR			
		4 SET/S	SIDE TABLE IN HPL FINISH 400MM X 400MM X 500MM HT. WITH METAL LEGS			G5	8 SET/S	MARIGOLD			
		6 SET/S	SQUARE PANTRY TABLE IN HPL FINISH 800MM X 800MM X 750MM HT. WITH METAL X-LEGS			R1	24 SET/S	RABAMI			
		5 SET/S	SQUARE PANTRY TABLE IN HPL FINISH 600MM X 600MM X 750MM HT. WITH METAL X-LEGS			S1	2 SET/S	KAYU SOFA 2 - SEATER			