

2 14TH FLOOR WALL SETTING-OUT PLAN
A-613 SCALE 1:100 M.

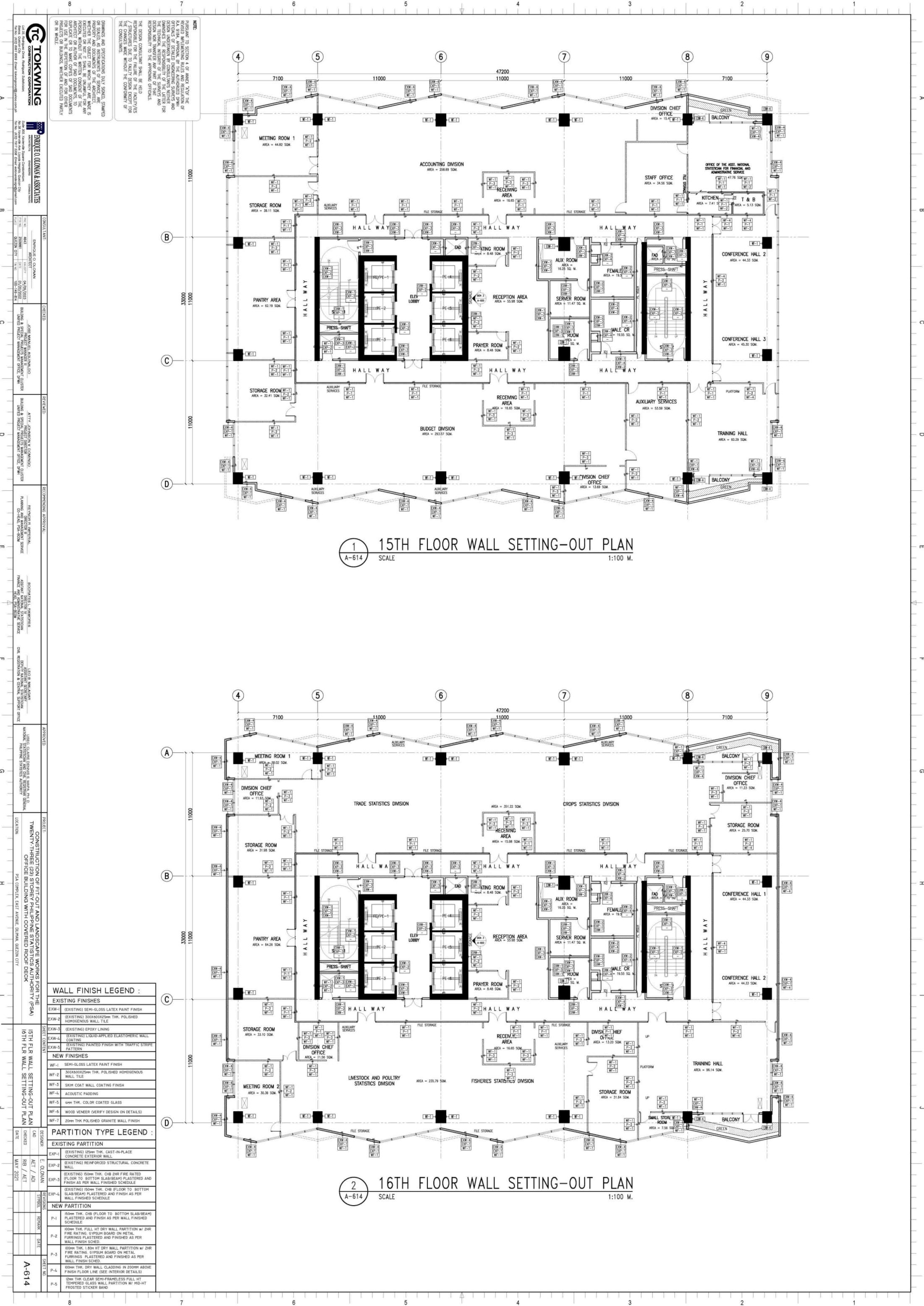

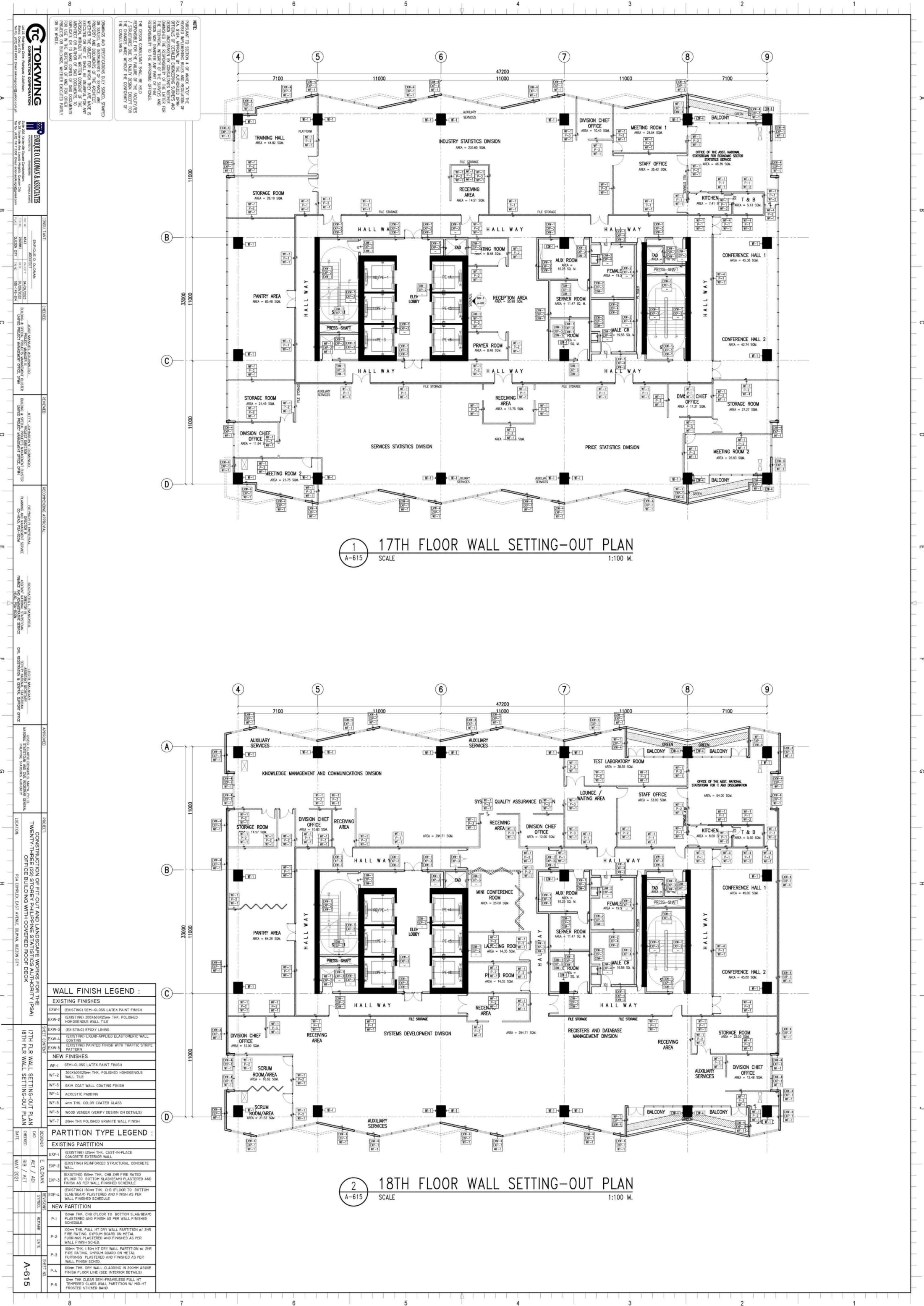

TOKWING
CONSTRUCTION CORPORATION
1234 Street, New York, NY 10001
Tel: 212 123 4567 Fax: 212 123 4568 Email: info@tokwing.com

PROJECT
CONSTRUCTION OF FIT-OUT AND LANDSCAPE WORKS FOR THE
TWENTY-THREE (23) STOREY PHILIPPINE STATISTICS AUTHORITY (PSA)
OFFICE BUILDING WITH COVERED ROOF DECK
18TH FLOOR WALL SETTING-OUT PLAN

DESIGNER
E. O. OLANA
DATE
MAY 2021

REVISIONS

NO.	DESCRIPTION	DATE
1	ISSUED FOR PERMIT	
2	ISSUED FOR PERMIT	
3	ISSUED FOR PERMIT	
4	ISSUED FOR PERMIT	
5	ISSUED FOR PERMIT	

WALL FINISH LEGEND :

EXISTING FINISHES

NO.	DESCRIPTION
EXW-1	(EXISTING) SEMI-GLOSS LATEX PAINT FINISH
EXW-2	(EXISTING) 300x600x25mm THK. POLISHED HOMOGENOUS WALL TILE
EXW-3	(EXISTING) EPOXY LINING
EXW-4	(EXISTING) LIQUID-APPLIED ELASTOMERIC WALL COATING
EXW-5	(EXISTING) PAINTED FINISH WITH TRAFFIC STRIPE PATTERN

NEW FINISHES

NO.	DESCRIPTION
WF-1	SEMI-GLOSS LATEX PAINT FINISH
WF-2	300x600x25mm THK. POLISHED HOMOGENOUS WALL TILE
WF-3	SKIM COAT WALL COATING FINISH
WF-4	ACOUSTIC PADDING
WF-5	4mm THK. COLOR COATED GLASS
WF-6	WOOD VENEER (VERIFY DESIGN ON DETAILS)
WF-7	20mm THK POLISHED GRANITE WALL FINISH

PARTITION TYPE LEGEND :

EXISTING PARTITION

NO.	DESCRIPTION
EXP-1	(EXISTING) 125mm THK. CAST-IN-PLACE CONCRETE EXTERIOR WALL
EXP-2	(EXISTING) REINFORCED STRUCTURAL CONCRETE WALL
EXP-3	(EXISTING) 100mm THK. CHB 2HR FIRE RATED FLOOR TO BOTTOM SLAB(BEAM) PLASTERED AND FINISH AS PER WALL FINISHED SCHEDULE
EXP-4	(EXISTING) 150mm THK. CHB (FLOOR TO BOTTOM SLAB(BEAM) PLASTERED AND FINISH AS PER WALL FINISHED SCHEDULE

NEW PARTITION

NO.	DESCRIPTION
P-1	150mm THK. CHB (FLOOR TO BOTTOM SLAB(BEAM) PLASTERED AND FINISH AS PER WALL FINISHED SCHEDULE
P-2	100mm THK. FULL HT DRY WALL PARTITION w/ 2HR FIRE RATING, GYPSUM BOARD ON METAL FURRINGS PLASTERED AND FINISHED AS PER WALL FINISH SCHED
P-3	100mm THK. 1800 HT DRY WALL PARTITION w/ 2HR FIRE RATING, GYPSUM BOARD ON METAL FURRINGS PLASTERED AND FINISHED AS PER WALL FINISH SCHED
P-4	100mm THK. DRY WALL CLADDING IN 200MM ABOVE FINISH FLOOR LINE (SEE INTERIOR DETAILS)
P-5	12mm THK CLEAR SEMI-FRAMELESS FULL HT THERMOPAN GLASS WALL PARTITION w/ MID-HT FROSTED STICKER BAND