

TOKWING
 CONSULTING ENGINEERS

PROJECT: CONSTRUCTION OF FIT-OUT AND LANDSCAPE WORKS FOR THE TWENTY-THREE (23) STOREY PHILIPPINE STATISTICS AUTHORITY (PSA) OFFICE BUILDING WITH COVERED ROOF DECK
 PSA CORNER, EAST AVENUE, DAVAO DEL NORTE CITY

DATE: MAY 2021

DESIGNER: E. O. OJANA
CHECKED: R.B. / A.D.
DATE: MAY 2021

REVISIONS:

NO.	DESCRIPTION	DATE
1	ISSUED FOR PERMIT	MAY 2021
2	FOR COMMENTS	MAY 2021
3	FOR COMMENTS	MAY 2021
4	FOR COMMENTS	MAY 2021
5	FOR COMMENTS	MAY 2021
6	FOR COMMENTS	MAY 2021
7	FOR COMMENTS	MAY 2021
8	FOR COMMENTS	MAY 2021
9	FOR COMMENTS	MAY 2021
10	FOR COMMENTS	MAY 2021
11	FOR COMMENTS	MAY 2021
12	FOR COMMENTS	MAY 2021
13	FOR COMMENTS	MAY 2021
14	FOR COMMENTS	MAY 2021
15	FOR COMMENTS	MAY 2021
16	FOR COMMENTS	MAY 2021
17	FOR COMMENTS	MAY 2021
18	FOR COMMENTS	MAY 2021
19	FOR COMMENTS	MAY 2021
20	FOR COMMENTS	MAY 2021
21	FOR COMMENTS	MAY 2021
22	FOR COMMENTS	MAY 2021
23	FOR COMMENTS	MAY 2021
24	FOR COMMENTS	MAY 2021
25	FOR COMMENTS	MAY 2021
26	FOR COMMENTS	MAY 2021
27	FOR COMMENTS	MAY 2021
28	FOR COMMENTS	MAY 2021
29	FOR COMMENTS	MAY 2021
30	FOR COMMENTS	MAY 2021
31	FOR COMMENTS	MAY 2021
32	FOR COMMENTS	MAY 2021
33	FOR COMMENTS	MAY 2021
34	FOR COMMENTS	MAY 2021
35	FOR COMMENTS	MAY 2021
36	FOR COMMENTS	MAY 2021
37	FOR COMMENTS	MAY 2021
38	FOR COMMENTS	MAY 2021
39	FOR COMMENTS	MAY 2021
40	FOR COMMENTS	MAY 2021
41	FOR COMMENTS	MAY 2021
42	FOR COMMENTS	MAY 2021
43	FOR COMMENTS	MAY 2021
44	FOR COMMENTS	MAY 2021
45	FOR COMMENTS	MAY 2021
46	FOR COMMENTS	MAY 2021
47	FOR COMMENTS	MAY 2021
48	FOR COMMENTS	MAY 2021
49	FOR COMMENTS	MAY 2021
50	FOR COMMENTS	MAY 2021

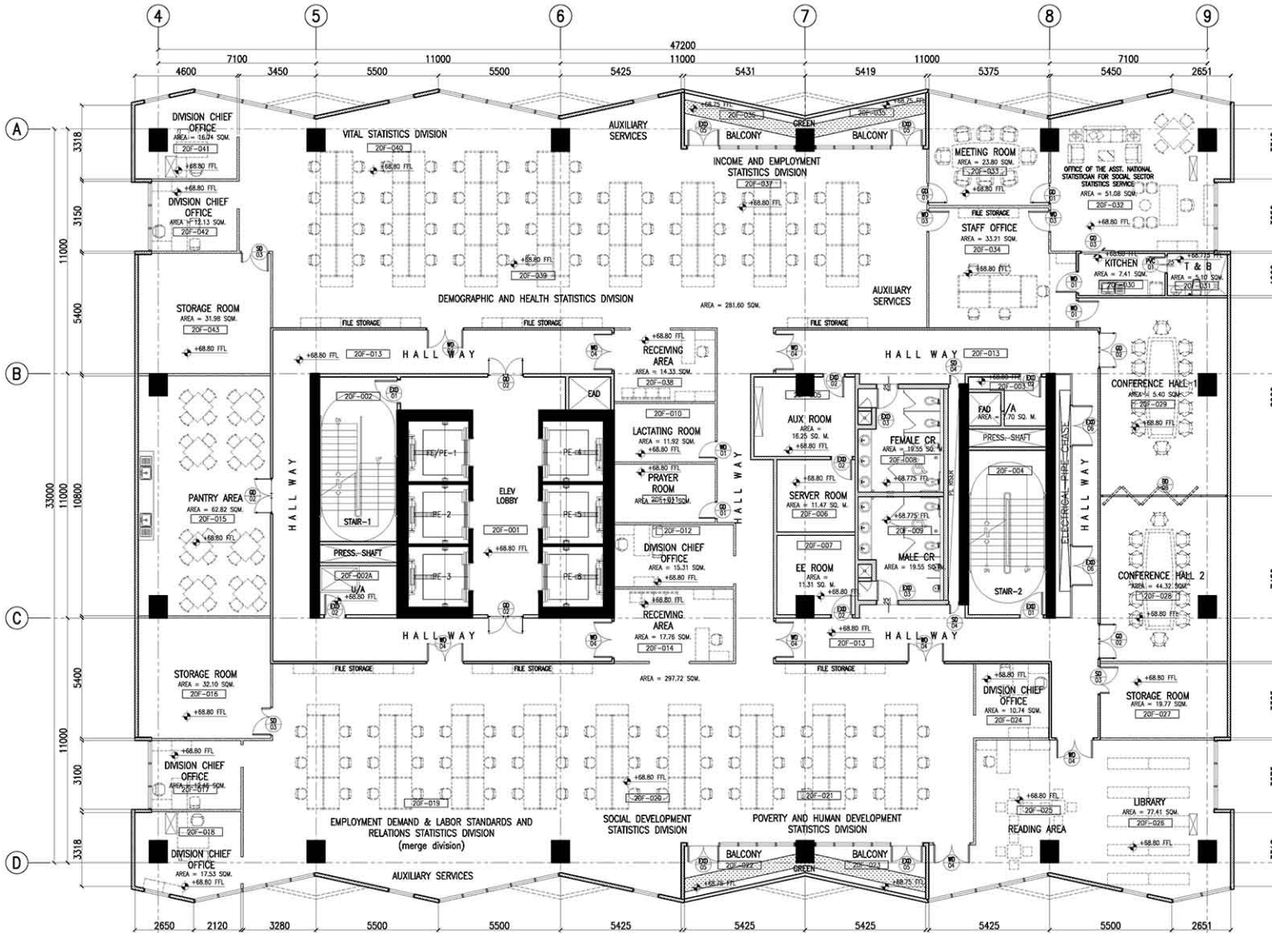
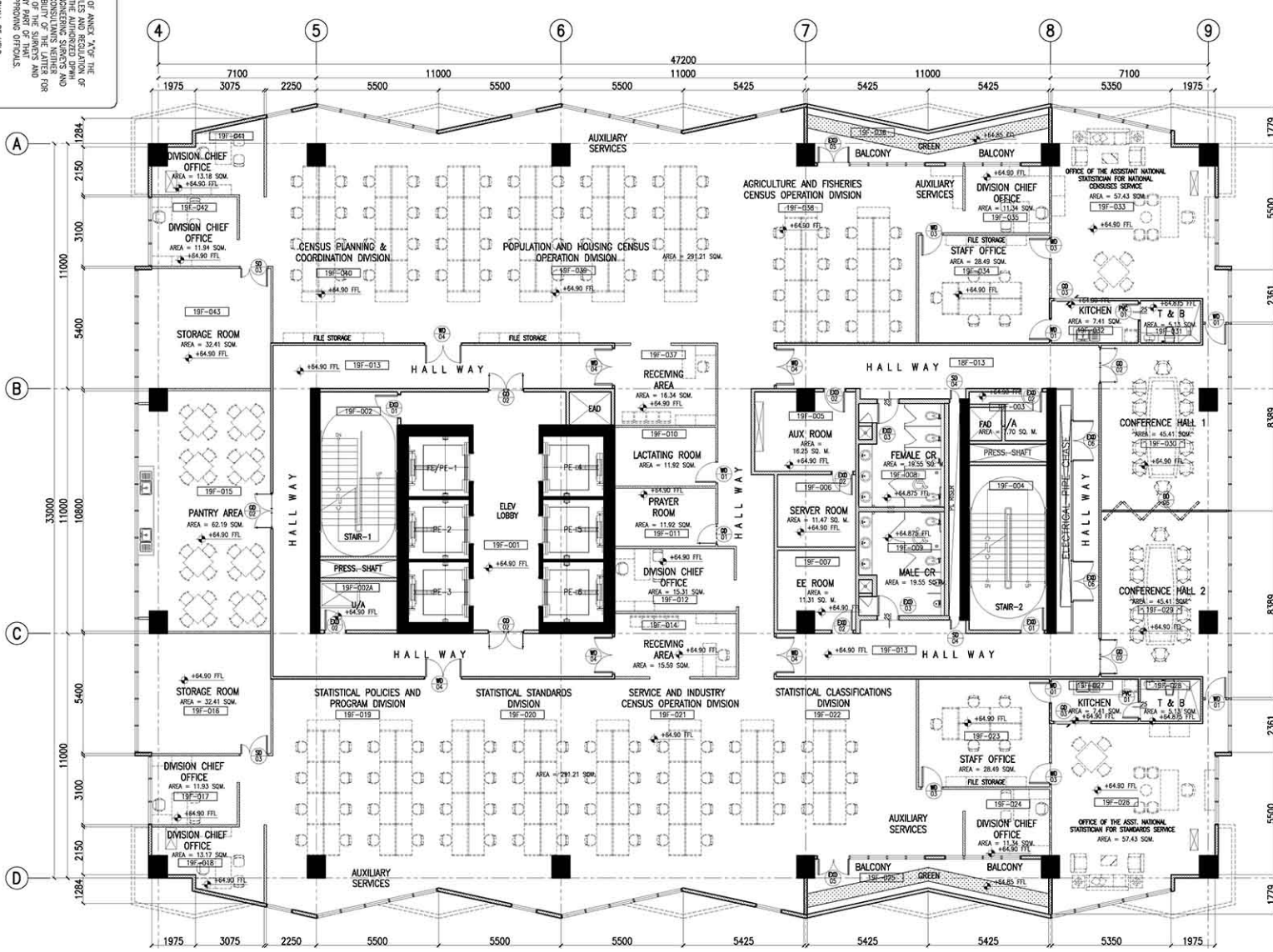

NOTES:

1. REFER TO SECTION 4 OF ANNEX 'A' OF THE PERMITTING REGULATIONS AND REGULATIONS OF THE PHILIPPINE STATISTICS AUTHORITY FOR THE DETAILS OF THE ARCHITECTURAL AND ELECTRICAL WORKS. THE CONTRACTOR SHALL BE RESPONSIBLE FOR THE PROVISION OF ALL MATERIALS AND LABORERS FOR THE CONSTRUCTION OF THE WORKS. THE CONTRACTOR SHALL BE RESPONSIBLE FOR THE PROTECTION OF ALL EXISTING UTILITIES AND STRUCTURES TO REMAIN EXCEPT FOR THE WORKS TO BE CONSTRUCTED.

2. THE CONTRACTOR SHALL BE RESPONSIBLE FOR THE PROTECTION OF ALL EXISTING UTILITIES AND STRUCTURES TO REMAIN EXCEPT FOR THE WORKS TO BE CONSTRUCTED.

3. THE CONTRACTOR SHALL BE RESPONSIBLE FOR THE PROTECTION OF ALL EXISTING UTILITIES AND STRUCTURES TO REMAIN EXCEPT FOR THE WORKS TO BE CONSTRUCTED.

4. THE CONTRACTOR SHALL BE RESPONSIBLE FOR THE PROTECTION OF ALL EXISTING UTILITIES AND STRUCTURES TO REMAIN EXCEPT FOR THE WORKS TO BE CONSTRUCTED.

5. THE CONTRACTOR SHALL BE RESPONSIBLE FOR THE PROTECTION OF ALL EXISTING UTILITIES AND STRUCTURES TO REMAIN EXCEPT FOR THE WORKS TO BE CONSTRUCTED.

6. THE CONTRACTOR SHALL BE RESPONSIBLE FOR THE PROTECTION OF ALL EXISTING UTILITIES AND STRUCTURES TO REMAIN EXCEPT FOR THE WORKS TO BE CONSTRUCTED.

7. THE CONTRACTOR SHALL BE RESPONSIBLE FOR THE PROTECTION OF ALL EXISTING UTILITIES AND STRUCTURES TO REMAIN EXCEPT FOR THE WORKS TO BE CONSTRUCTED.

8. THE CONTRACTOR SHALL BE RESPONSIBLE FOR THE PROTECTION OF ALL EXISTING UTILITIES AND STRUCTURES TO REMAIN EXCEPT FOR THE WORKS TO BE CONSTRUCTED.

9. THE CONTRACTOR SHALL BE RESPONSIBLE FOR THE PROTECTION OF ALL EXISTING UTILITIES AND STRUCTURES TO REMAIN EXCEPT FOR THE WORKS TO BE CONSTRUCTED.

10. THE CONTRACTOR SHALL BE RESPONSIBLE FOR THE PROTECTION OF ALL EXISTING UTILITIES AND STRUCTURES TO REMAIN EXCEPT FOR THE WORKS TO BE CONSTRUCTED.

11. THE CONTRACTOR SHALL BE RESPONSIBLE FOR THE PROTECTION OF ALL EXISTING UTILITIES AND STRUCTURES TO REMAIN EXCEPT FOR THE WORKS TO BE CONSTRUCTED.

12. THE CONTRACTOR SHALL BE RESPONSIBLE FOR THE PROTECTION OF ALL EXISTING UTILITIES AND STRUCTURES TO REMAIN EXCEPT FOR THE WORKS TO BE CONSTRUCTED.

13. THE CONTRACTOR SHALL BE RESPONSIBLE FOR THE PROTECTION OF ALL EXISTING UTILITIES AND STRUCTURES TO REMAIN EXCEPT FOR THE WORKS TO BE CONSTRUCTED.

14. THE CONTRACTOR SHALL BE RESPONSIBLE FOR THE PROTECTION OF ALL EXISTING UTILITIES AND STRUCTURES TO REMAIN EXCEPT FOR THE WORKS TO BE CONSTRUCTED.

15. THE CONTRACTOR SHALL BE RESPONSIBLE FOR THE PROTECTION OF ALL EXISTING UTILITIES AND STRUCTURES TO REMAIN EXCEPT FOR THE WORKS TO BE CONSTRUCTED.

16. THE CONTRACTOR SHALL BE RESPONSIBLE FOR THE PROTECTION OF ALL EXISTING UTILITIES AND STRUCTURES TO REMAIN EXCEPT FOR THE WORKS TO BE CONSTRUCTED.

17. THE CONTRACTOR SHALL BE RESPONSIBLE FOR THE PROTECTION OF ALL EXISTING UTILITIES AND STRUCTURES TO REMAIN EXCEPT FOR THE WORKS TO BE CONSTRUCTED.

18. THE CONTRACTOR SHALL BE RESPONSIBLE FOR THE PROTECTION OF ALL EXISTING UTILITIES AND STRUCTURES TO REMAIN EXCEPT FOR THE WORKS TO BE CONSTRUCTED.

19. THE CONTRACTOR SHALL BE RESPONSIBLE FOR THE PROTECTION OF ALL EXISTING UTILITIES AND STRUCTURES TO REMAIN EXCEPT FOR THE WORKS TO BE CONSTRUCTED.

20. THE CONTRACTOR SHALL BE RESPONSIBLE FOR THE PROTECTION OF ALL EXISTING UTILITIES AND STRUCTURES TO REMAIN EXCEPT FOR THE WORKS TO BE CONSTRUCTED.

21. THE CONTRACTOR SHALL BE RESPONSIBLE FOR THE PROTECTION OF ALL EXISTING UTILITIES AND STRUCTURES TO REMAIN EXCEPT FOR THE WORKS TO BE CONSTRUCTED.

22. THE CONTRACTOR SHALL BE RESPONSIBLE FOR THE PROTECTION OF ALL EXISTING UTILITIES AND STRUCTURES TO REMAIN EXCEPT FOR THE WORKS TO BE CONSTRUCTED.

23. THE CONTRACTOR SHALL BE RESPONSIBLE FOR THE PROTECTION OF ALL EXISTING UTILITIES AND STRUCTURES TO REMAIN EXCEPT FOR THE WORKS TO BE CONSTRUCTED.

24. THE CONTRACTOR SHALL BE RESPONSIBLE FOR THE PROTECTION OF ALL EXISTING UTILITIES AND STRUCTURES TO REMAIN EXCEPT FOR THE WORKS TO BE CONSTRUCTED.

25. THE CONTRACTOR SHALL BE RESPONSIBLE FOR THE PROTECTION OF ALL EXISTING UTILITIES AND STRUCTURES TO REMAIN EXCEPT FOR THE WORKS TO BE CONSTRUCTED.

26. THE CONTRACTOR SHALL BE RESPONSIBLE FOR THE PROTECTION OF ALL EXISTING UTILITIES AND STRUCTURES TO REMAIN EXCEPT FOR THE WORKS TO BE CONSTRUCTED.

27. THE CONTRACTOR SHALL BE RESPONSIBLE FOR THE PROTECTION OF ALL EXISTING UTILITIES AND STRUCTURES TO REMAIN EXCEPT FOR THE WORKS TO BE CONSTRUCTED.

28. THE CONTRACTOR SHALL BE RESPONSIBLE FOR THE PROTECTION OF ALL EXISTING UTILITIES AND STRUCTURES TO REMAIN EXCEPT FOR THE WORKS TO BE CONSTRUCTED.

29. THE CONTRACTOR SHALL BE RESPONSIBLE FOR THE PROTECTION OF ALL EXISTING UTILITIES AND STRUCTURES TO REMAIN EXCEPT FOR THE WORKS TO BE CONSTRUCTED.

30. THE CONTRACTOR SHALL BE RESPONSIBLE FOR THE PROTECTION OF ALL EXISTING UTILITIES AND STRUCTURES TO REMAIN EXCEPT FOR THE WORKS TO BE CONSTRUCTED.

31. THE CONTRACTOR SHALL BE RESPONSIBLE FOR THE PROTECTION OF ALL EXISTING UTILITIES AND STRUCTURES TO REMAIN EXCEPT FOR THE WORKS TO BE CONSTRUCTED.

32. THE CONTRACTOR SHALL BE RESPONSIBLE FOR THE PROTECTION OF ALL EXISTING UTILITIES AND STRUCTURES TO REMAIN EXCEPT FOR THE WORKS TO BE CONSTRUCTED.

33. THE CONTRACTOR SHALL BE RESPONSIBLE FOR THE PROTECTION OF ALL EXISTING UTILITIES AND STRUCTURES TO REMAIN EXCEPT FOR THE WORKS TO BE CONSTRUCTED.

34. THE CONTRACTOR SHALL BE RESPONSIBLE FOR THE PROTECTION OF ALL EXISTING UTILITIES AND STRUCTURES TO REMAIN EXCEPT FOR THE WORKS TO BE CONSTRUCTED.

35. THE CONTRACTOR SHALL BE RESPONSIBLE FOR THE PROTECTION OF ALL EXISTING UTILITIES AND STRUCTURES TO REMAIN EXCEPT FOR THE WORKS TO BE CONSTRUCTED.

36. THE CONTRACTOR SHALL BE RESPONSIBLE FOR THE PROTECTION OF ALL EXISTING UTILITIES AND STRUCTURES TO REMAIN EXCEPT FOR THE WORKS TO BE CONSTRUCTED.

37. THE CONTRACTOR SHALL BE RESPONSIBLE FOR THE PROTECTION OF ALL EXISTING UTILITIES AND STRUCTURES TO REMAIN EXCEPT FOR THE WORKS TO BE CONSTRUCTED.

38. THE CONTRACTOR SHALL BE RESPONSIBLE FOR THE PROTECTION OF ALL EXISTING UTILITIES AND STRUCTURES TO REMAIN EXCEPT FOR THE WORKS TO BE CONSTRUCTED.

39. THE CONTRACTOR SHALL BE RESPONSIBLE FOR THE PROTECTION OF ALL EXISTING UTILITIES AND STRUCTURES TO REMAIN EXCEPT FOR THE WORKS TO BE CONSTRUCTED.

40. THE CONTRACTOR SHALL BE RESPONSIBLE FOR THE PROTECTION OF ALL EXISTING UTILITIES AND STRUCTURES TO REMAIN EXCEPT FOR THE WORKS TO BE CONSTRUCTED.

41. THE CONTRACTOR SHALL BE RESPONSIBLE FOR THE PROTECTION OF ALL EXISTING UTILITIES AND STRUCTURES TO REMAIN EXCEPT FOR THE WORKS TO BE CONSTRUCTED.

42. THE CONTRACTOR SHALL BE RESPONSIBLE FOR THE PROTECTION OF ALL EXISTING UTILITIES AND STRUCTURES TO REMAIN EXCEPT FOR THE WORKS TO BE CONSTRUCTED.

43. THE CONTRACTOR SHALL BE RESPONSIBLE FOR THE PROTECTION OF ALL EXISTING UTILITIES AND STRUCTURES TO REMAIN EXCEPT FOR THE WORKS TO BE CONSTRUCTED.

44. THE CONTRACTOR SHALL BE RESPONSIBLE FOR THE PROTECTION OF ALL EXISTING UTILITIES AND STRUCTURES TO REMAIN EXCEPT FOR THE WORKS TO BE CONSTRUCTED.

45. THE CONTRACTOR SHALL BE RESPONSIBLE FOR THE PROTECTION OF ALL EXISTING UTILITIES AND STRUCTURES TO REMAIN EXCEPT FOR THE WORKS TO BE CONSTRUCTED.

46. THE CONTRACTOR SHALL BE RESPONSIBLE FOR THE PROTECTION OF ALL EXISTING UTILITIES AND STRUCTURES TO REMAIN EXCEPT FOR THE WORKS TO BE CONSTRUCTED.

47. THE CONTRACTOR SHALL BE RESPONSIBLE FOR THE PROTECTION OF ALL EXISTING UTILITIES AND STRUCTURES TO REMAIN EXCEPT FOR THE WORKS TO BE CONSTRUCTED.

48. THE CONTRACTOR SHALL BE RESPONSIBLE FOR THE PROTECTION OF ALL EXISTING UTILITIES AND STRUCTURES TO REMAIN EXCEPT FOR THE WORKS TO BE CONSTRUCTED.

49. THE CONTRACTOR SHALL BE RESPONSIBLE FOR THE PROTECTION OF ALL EXISTING UTILITIES AND STRUCTURES TO REMAIN EXCEPT FOR THE WORKS TO BE CONSTRUCTED.

50. THE CONTRACTOR SHALL BE RESPONSIBLE FOR THE PROTECTION OF ALL EXISTING UTILITIES AND STRUCTURES TO REMAIN EXCEPT FOR THE WORKS TO BE CONSTRUCTED.

TOKWING
 CONSULTANTS
 ARCHITECTS
 ENGINEERS
 INTERIORS
 ENVIRONMENTAL DESIGNERS
 PLANNING & MANAGEMENT CONSULTANTS
 PROJECT: CONSTRUCTION OF FIT-OUT AND LANDSCAPE WORKS FOR THE TWENTY-THREE (23) STOREY PHILIPPINE STATISTICS AUTHORITY (PSA) OFFICE BUILDING WITH COVERED ROOF DECK
 LOCATION: PSA CORNER EAST AVENUE, DUMAGUITE CITY
 SHEET CONTENT: 21ST FLOOR PLAN
 DESIGNER: E. O. OJANA
 CHECKED: R. O. OJANA
 DATE: MAY 2021
 SHEET NO: A-216

NOTE:
 1. REFER TO SECTION 4 OF ANNEX 'A' OF THE PERMITS TO CONSTRUCT AND RECORDING OF PLANS FOR THE PROPOSED COVERED ROOF DECK.
 2. THE CONTRACTOR SHALL BE RESPONSIBLE FOR THE PROTECTION OF THE EXISTING UTILITIES AND STRUCTURES DUE TO FAULTY DESIGN OR CONSTRUCTION OF THE COVERED ROOF DECK.
 3. THE CONTRACTOR SHALL BE RESPONSIBLE FOR THE PROTECTION OF THE EXISTING UTILITIES AND STRUCTURES DUE TO FAULTY DESIGN OR CONSTRUCTION OF THE COVERED ROOF DECK.
 4. THE CONTRACTOR SHALL BE RESPONSIBLE FOR THE PROTECTION OF THE EXISTING UTILITIES AND STRUCTURES DUE TO FAULTY DESIGN OR CONSTRUCTION OF THE COVERED ROOF DECK.

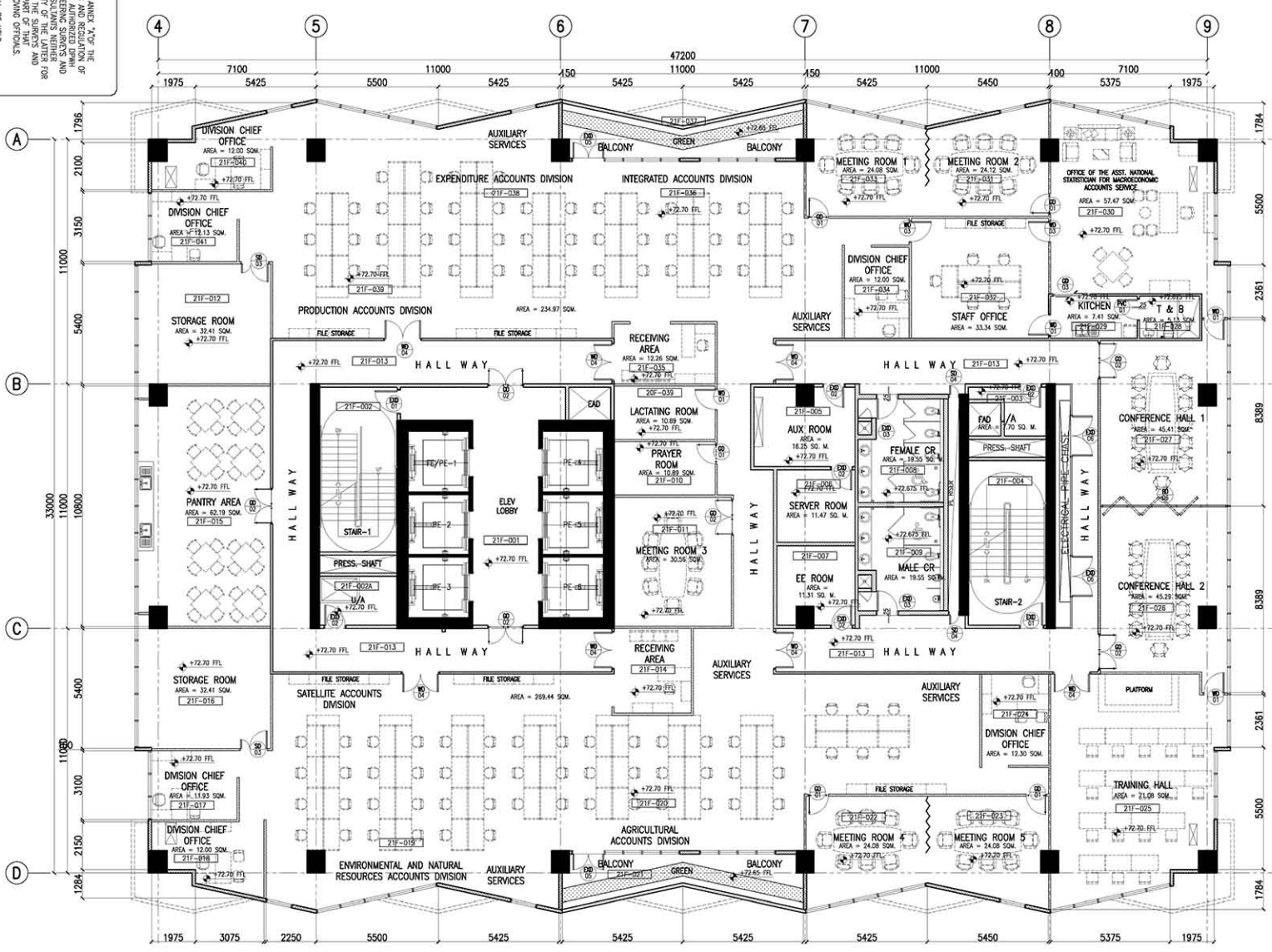

1 21ST FLOOR PLAN
 SCALE 1:1100 M.

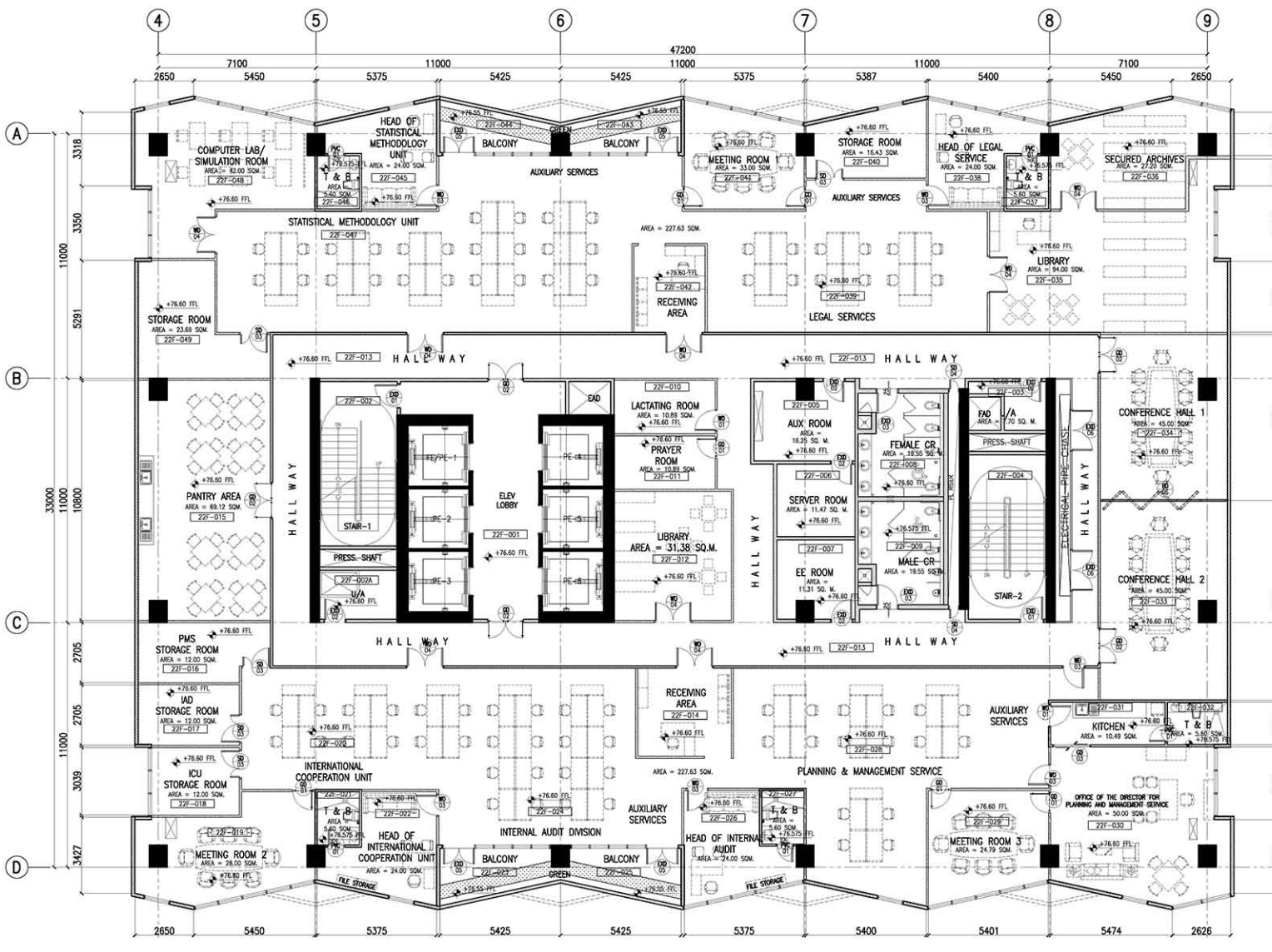

TOKWING
 CONSULTANTS
 ARCHITECTS
 ENGINEERS
 INTERIORS
 ENVIRONMENTAL DESIGNERS
 PLANNING & MANAGEMENT CONSULTANTS
 PROJECT: CONSTRUCTION OF FIT-OUT AND LANDSCAPE WORKS FOR THE TWENTY-THREE (23) STOREY PHILIPPINE STATISTICS AUTHORITY (PSA) OFFICE BUILDING WITH COVERED ROOF DECK
 LOCATION: PSA CORNER EAST AVENUE, DUMAGUITE CITY
 SHEET CONTENT: 21ST FLOOR PLAN
 DESIGNER: E. O. OJANA
 CHECKED: R. O. OJANA
 DATE: MAY 2021
 SHEET NO: A-216

87654321

ABCDEFGHIJ

71001100047200110007100

55001100011555500

19755350542554255425290024505400540053751975

71005425557554254439106155005500550055002650

254570003318

ABCD

80331100014600

7967110003450345033003318

2575557554255425448996155505500550055002650

239671003318

ABCD

87654321

TOKWING
CONSTRUCTION CONSULTANTS

ENGINEER O. OLANNA & ASSOCIATES
ARCHITECT

CONSULTANT
ARCHITECT

REVIEWED
ARCHITECT

RECOMMENDING APPROVAL
ARCHITECT

APPROVED
ARCHITECT

PROJECT
CONSTRUCTION OF FIT-OUT AND LANDSCAPE WORKS FOR THE TWENTY-THREE (23) STOREY PHILIPPINE STATISTICS AUTHORITY (PSA) OFFICE BUILDING WITH COVERED ROOF DECK
PSA CORNER EAST AVENUE, DILIMAN, QUEZON CITY

SHEET CONTENT
23RD FLOOR PLAN
24TH FLOOR PLAN

DESIGNED
O. OLANNA

CHECKED
R.B. / L.E.T.

DATE
MAY 2021

SHEET NO.
A-217

NOTE:
 1. REFER TO SECTION 4 OF ANNEX 'A' OF THE PERMISSIVE REGULATIONS AND REGULATIONS OF THE PHILIPPINE ARCHITECTURAL BOARD FOR THE DESIGN OF COVERED ROOF DECKS AND DISSEMINATE THE RESPONSIBILITY OF THE DESIGNER FOR THE DESIGN, CONSTRUCTION AND MAINTENANCE OF THE COVERED ROOF DECKS AND DISSEMINATE THE RESPONSIBILITY OF THE DESIGNER FOR THE DESIGN, CONSTRUCTION AND MAINTENANCE OF THE COVERED ROOF DECKS.
 2. THE DESIGNER SHALL BE RESPONSIBLE FOR THE DESIGN OF THE COVERED ROOF DECKS AND DISSEMINATE THE RESPONSIBILITY OF THE DESIGNER FOR THE DESIGN, CONSTRUCTION AND MAINTENANCE OF THE COVERED ROOF DECKS.
 3. THE DESIGNER SHALL BE RESPONSIBLE FOR THE DESIGN OF THE COVERED ROOF DECKS AND DISSEMINATE THE RESPONSIBILITY OF THE DESIGNER FOR THE DESIGN, CONSTRUCTION AND MAINTENANCE OF THE COVERED ROOF DECKS.
 4. THE DESIGNER SHALL BE RESPONSIBLE FOR THE DESIGN OF THE COVERED ROOF DECKS AND DISSEMINATE THE RESPONSIBILITY OF THE DESIGNER FOR THE DESIGN, CONSTRUCTION AND MAINTENANCE OF THE COVERED ROOF DECKS.

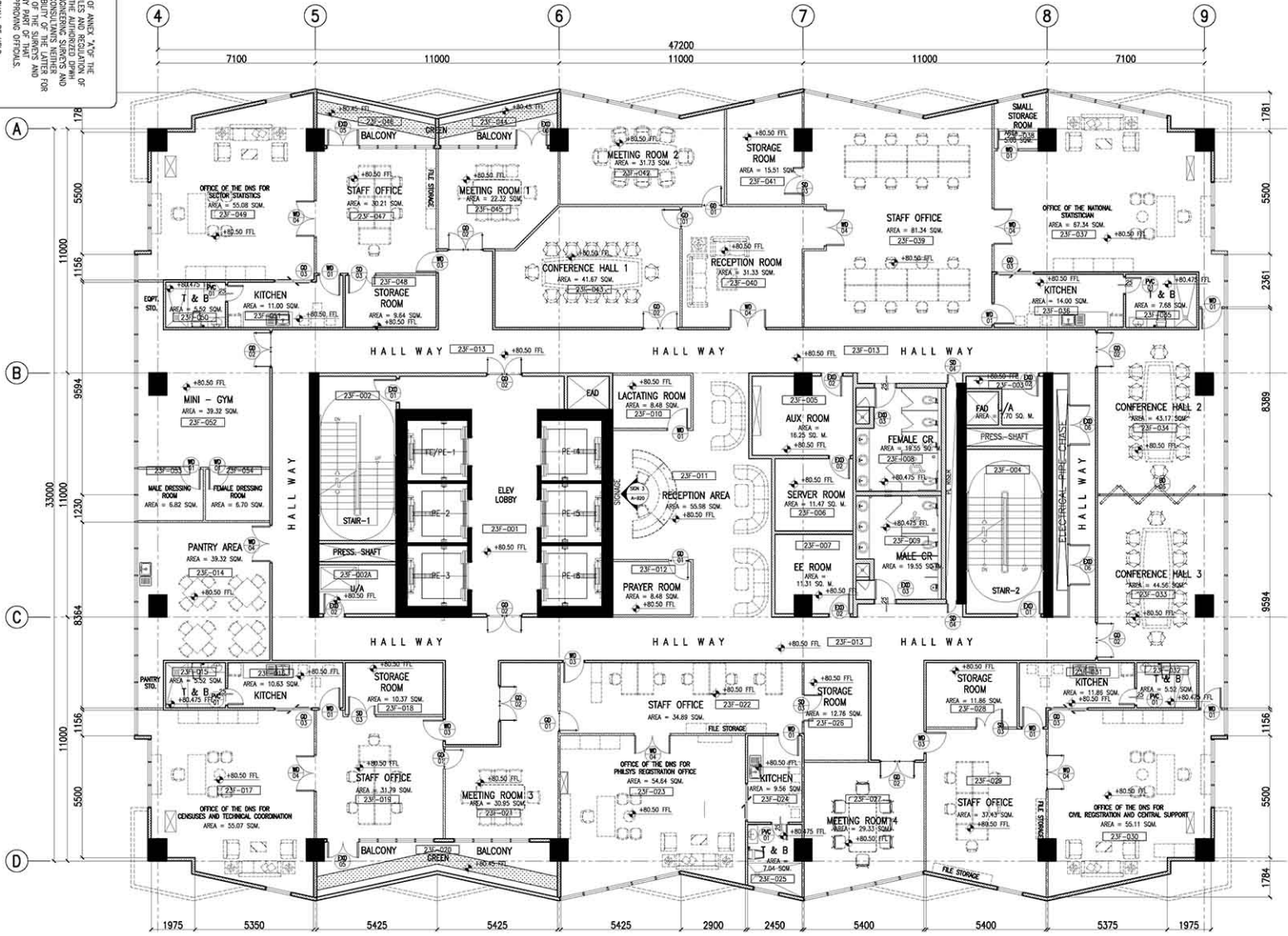

1 23RD FLOOR PLAN
A-217 SCALE 1:100 M.

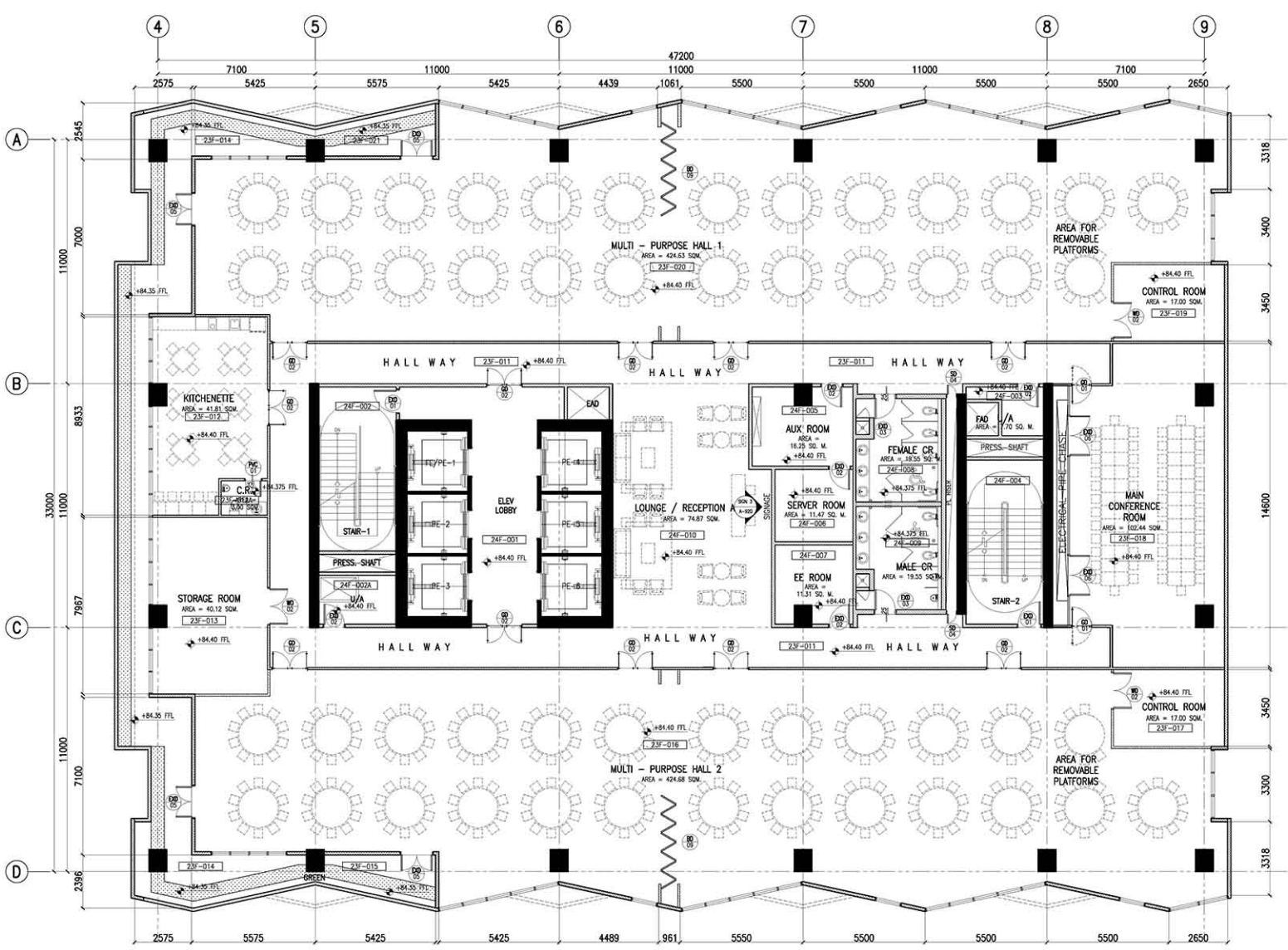

2 24TH FLOOR PLAN
A-217 SCALE 1:100 M.

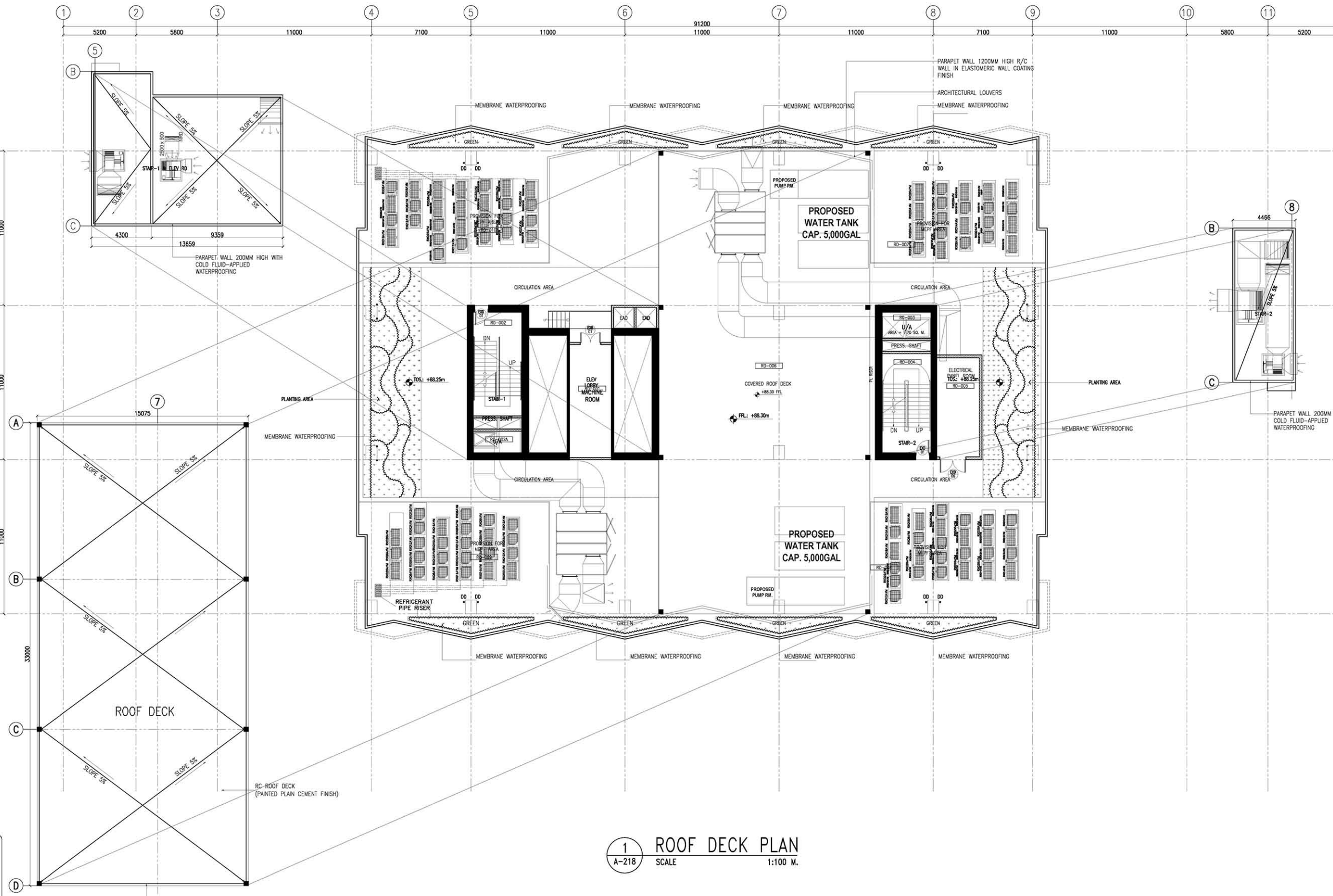

1 ROOF DECK PLAN
 A-218 SCALE 1:100 M.

NOTE:
 PURSUANT TO SECTION 4 OF ANNEX "A" OF THE REVISED IMPLEMENTING RULES AND REGULATION OF R.A. 9164, APPROVAL BY THE AUTHORIZED DPWH OFFICIALS OF DETAILED ENGINEERING SURVEYS AND DESIGN UNDERTAKEN BY CONSULTANTS NEITHER TRANSFERS THE RESPONSIBILITY OF THE LATTER FOR THE TECHNICAL INTEGRITY OF THE SURVEYS AND DESIGN NOR TRANSFER ANY PART OF THAT RESPONSIBILITY TO THE APPROVING OFFICIALS.
 THE DESIGN CONSULTANT SHALL BE HELD RESPONSIBLE FOR THE FAILURE OF THE FACILITY/ES / STRUCTURES DUE TO FAULTY DESIGN EXCEPT FOR THE CHANGES MADE WITHOUT THE CONFORMITY OF THE CONSULTANTS.

DRAWINGS AND SPECIFICATIONS DULY SIGNED, STAMPED OR SEALED, AS INSTRUMENTS OF SERVICE, ARE PROPERTY AND DOCUMENTS OF THE ARCHITECT, WHETHER THE OBJECT FOR WHICH THEY ARE MADE IS EXECUTED OR NOT. IT SHALL BE UNLAWFUL FOR ANY PERSON, WITHOUT THE WRITTEN CONSENT OF THE ARCHITECT OR AUTHOR OF SAID DOCUMENTS, TO DUPLICATE OR TO MAKE COPIES OF SAID DOCUMENTS FOR USE IN THE REPEITION OF AND FOR OTHER PROJECTS OR BUILDINGS, WHETHER EXECUTED PARTLY OR IN WHOLE.

		CONSULTANT:	ENRIQUE O. OLANAN	CHECKED:		REVIEWED:		RECOMMENDING APPROVAL:		APPROVED:		PROJECT:	CONSTRUCTION OF FIT-OUT AND LANDSCAPE WORKS FOR THE TWENTY-THREE (23) STOREY PHILIPPINE STATISTICS AUTHORITY (PSA) OFFICE BUILDING WITH COVERED ROOF DECK	SHEET CONTENT:	ROOF DECK PLAN	DESIGNER:	E. OLANAN	REVISIONS:		SHEET NO.:	A-218
		ARCHITECT:	ENRIQUE O. OLANAN	PROJECT MANAGER II:	JOSE MANUEL AGUIBALDO	PROJECT DIRECTOR:	ATTY. JOHNSON V. DOMINGO	PROJECT MANAGER I:	REYNOR R. IMPERIAL	ASSISTANT NATIONAL STATISTICIAN:	SOCRATES L. RAMORRES	DEPUTY NATIONAL STATISTICIAN:	LEO B. MALAGARI	NATIONAL STATISTICIAN AND CIVIL REGISTRAR GENERAL:	USLEG CLAIRE DENNIS S. MAPA, PH.D.	DATE:	MAY 2021	SYMBOL:		REMARK:	